

Live presentation

Brochure that will inspire you to create a presentation
ELKO / iNELS products on the right way



www.inels.com
www.elkoep.com

iNELS[®]

Case iNELS BUS III.

Intended for training and playing. Sample of controlling the switched and dimmable lighting, control blinds, heating circuit, irrigation, control by Touch panel, control using bus and classic buttons or through iHC application.

| Type | Name | EAN |
|------------------------|--|---------------|
| CU3-01M | Central unit | 8595188132220 |
| EST3 | Control unit with touch screen | 8595188179683 |
| SA3-06M | Switching actuator 6-channel | 8595188132879 |
| DA3-22M | Universal dimming actuator, 2-channel | 8595188132626 |
| IM3-80B | Binary input units | 8595188132329 |
| DAC3-04B | Digital-analog converter | 8595188132572 |
| GSB3-40/B | Glass wall touch controllers | 859518813909 |
| DLSL-GU10-250-3K | Economical LED bulb, warm white | 8595188165563 |
| ETIMAT 10 B 1p 10kA 6A | Breaker 1 Pole | 3838895242888 |
| BPS3-02M | Bus separator from power supply | 8595188132435 |
| PS3-100/iNELS | Power supply 100W, IN AC 85-253 V AC, OUT: 27.6/3.6 a 12.2V/0.35 A, 6A | 859518813158 |
| WSB3-40 | 4-button controller | 8595188132343 |
| 90920 TAL | 2-frames, CRYSTAL (glass, black) | 5603011595357 |
| 99611 TIS - grey | Cover of card switch | 8959188140874 |

Case iNELS Bus: Guest Room Management System (GRMS)

Presenting the iNELS Guest Room Management System case, it covers a comprehensive solution for the hotel environment. It contains the following components: Multifunction Touch Panel Glass Hotel Reader, Glass Thermostat, Fan-coil actuator, Central unit and Universal Dimmer. Simply example of switching; Master the lights or regulate the temperature in the room. The presentation case is suitable for self-education and especially as a demonstration of functionality for hoteliers.

| Type | Name | EAN |
|-------------------|--|---------------|
| PS3-100/iNELS | Power supply 100W, IN AC 85-253 V AC, OUT: 27.6/3.6 a 12.2V/0.35 A, 6A | 859518813158 |
| CU3-02M | Central unit | 8595188132398 |
| SA3-012M | Switching actuator 12-channel | 8595188132466 |
| D-Link GO-RT-N150 | Router | 8595188174107 |
| DLSL-GU10-350-3K | Economical LED bulb, warm white | 8595188165563 |
| SA3-06M | Switching actuator 6-channel | 8595188132879 |
| RFDA-73M/RGB | Dimmer for coloured (RGB) LED strips | 8595188146814 |
| DA3-22M | Universal dimming actuator 2-channel | 8595188132626 |
| LARA IC_grey | Music Player | 8595188149402 |
| IM3-80B | Binary input units | 8595188132329 |
| GHR3-11/B | Glass Hotel Reader | 8595188156271 |
| EHT3_white/white | Control unit with touch screen | 8595188156196 |
| GSB3-20/SB | Glass Touch Panel | 8595188156226 |
| GBP3-60/B | Glass Touch Panel | 8595188157285 |
| GRT3-50/B | Glass Touch Panel | 8595188156301 |
| GSP3-10/B | Glass Touch Panel | 8595188157261 |
| GCR3-11/B | Glass Touch Panel | 8595188156288 |
| GCH3-30/B | Glass Touch Panel | 8595188156271 |

LED signalization



input/output points

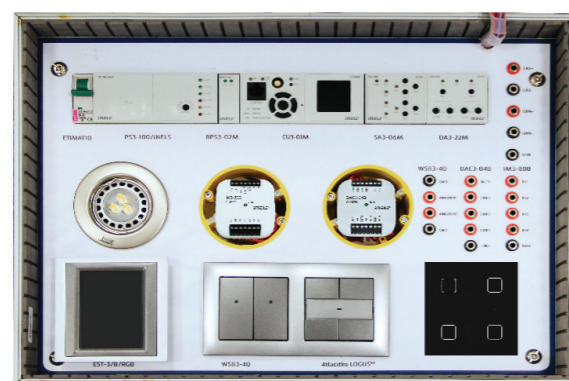

| Product number | Parameters | Price |
|-------------------|------------------------------|-------|
| Code 80256 | Dimension 330 x 455 x 150 mm | 725 € |
| EAN 8595188179638 | Weight 6,3 kg | |

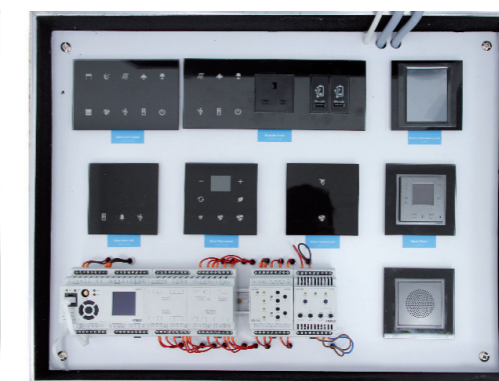

| Product number | Parameters | Price |
|-------------------|------------------------------|---------|
| Code 80384 | Dimension 596 x 455 x 150 mm | 4 131 € |
| EAN 8595188157810 | Weight 19,8 kg | |

Case iNELS Wireless (small)

Presenting the RF Control case, it covers a comprehensive solution for home automation. It contains the main system components: a touch unit, remote control, smart box for control via a smartphone and more. Functions that can be demonstrated: appliance switching, dimming lights and temperature control. The presentation case is particularly suitable for self-learning iNELS system partners.

| Type | Name | EAN |
|--------------------------|---|---------------|
| eLAN-RF-003 | Smart RF box | 8595188146845 |
| DLB-E27-806-2K7 | LED dimm - Dimmable LED bulb, warm | 8595188165563 |
| DLSL-GU10-250-3K | Economical LED bulb, warm white | 8595188163422 |
| RFDA-73M/RGB | Three-channel actuator for (RGB) LED strips | 8595188146814 |
| RFSA-66M/230V | Wireless switch unit - 6 outputs | 8595188142823 |
| RFSTI-11/G_white/white | Switch unit with a temperature sensor | 8595188142595 |
| RFSAI-61B | Wireless switch unit with the input | 8595188145893 |
| RGB LED strip | LIGHTING - LED strips | 8595188164269 |
| RFUS-61 | Switch unit for outdoor use | 8595188145268 |
| RF Pilot/White | Wireless remote controller with display | 8595188143769 |
| RFWD-100 | Door Detector | 8595188150279 |
| RFSC-61_French | Switching socket multi-function | 8595188145602 |
| RFJA-12B/12-24 V DC | Switch unit for shutters | 8595188140614 |
| RFWB-40/G | Wireless wall controller | 8595188140607 |
| RFATV-1 | Wireless thermo-valve | 8595188145138 |
| RFDAC-71B | Analog controller an actuator with analog output 0(1)-10V | 8595188142809 |
| RFDEL-71B | Universal dimmer - Multifunction dimming actuator | 8595188145121 |
| RFSOU-1 | Wireless twilight switch | 8595188147071 |
| RFIM-20B | Wireless contact converter | 8595188139274 |
| RF Key/W_white | Portable transmitter used to control RF Control units | 8595188143332 |
| RFTC-50/G_white | Wireless temperature controller | 8595188148757 |
| RFMD-100 | Motion detector | 8595188150293 |
| Router TP-link TL-WR702N | Router | |



| Product number | Parameters |
|-------------------|------------------------------|
| Code 80285 | Dimension 460 x 330 x 150 mm |
| EAN 8595188173841 | Weight 7,1 kg |

Case Smart City

The case demonstrates the management of technology and its effective contribution. Management of public lighting, parking lots, connection with cameras, lights, and building management forms the basis of 'SMART CITY'.

| Type | Name | EAN |
|------------|---|---------------|
| CU3-02M | Central unit | 8595188132398 |
| BPS3-01M | Bus separator from power supply | 8595188134442 |
| DAC3-04B | Digital-analog converter | 8595188132572 |
| RFUS-61 | Switch unit for outdoor use (multi-function) | 8595188145268 |
| PS-10-24V | Power supplies | 8595188139069 |
| PS-30-24V | Power supplies | 8595188139045 |
| PS-10-12 | Power supplies | 8595188139052 |
| IM3-80B | Binary input units | 8595188132329 |
| RF KEY/W | 4 button controller - keychain | 8595188143332 |
| iMM Client | Player videozone allowing control of all system functions through the TV screen | 8595188149334 |

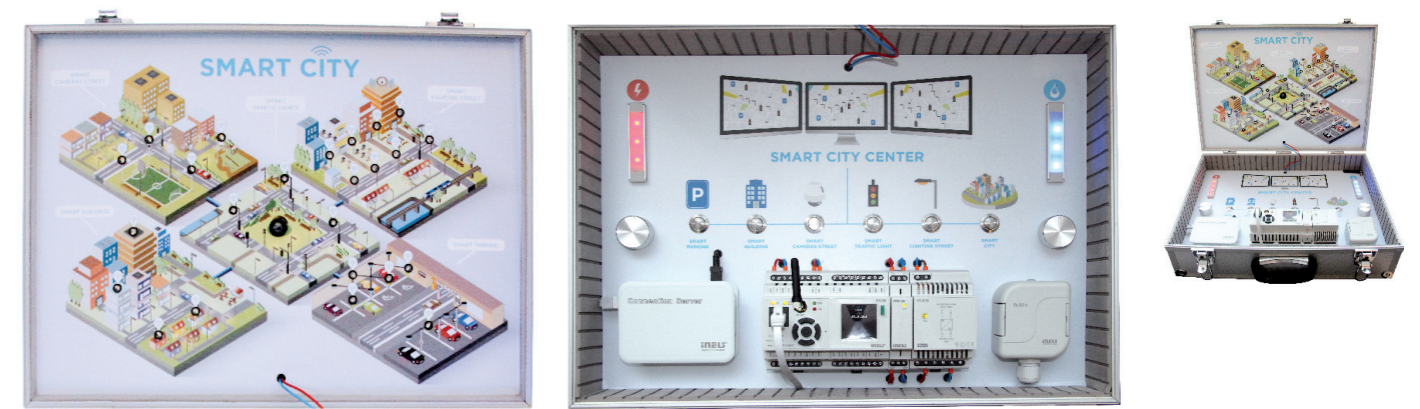

| Product number | Parameters | Price |
|----------------|------------------------------|---------|
| Code 80396 | Dimension 459 x 325 x 150 mm | 1 643 € |
| EAN - | Weight 5,2 kg | |

Case iNELS Wireless Hotel room energy saving kit

The presentation case is designed to demonstrate the automation of hotel rooms. Through it you can demonstrate the automatic control of lighting, shading techniques, effective temperature control and listening to music. The presentation case is suitable for self-education and especially to demonstrate the functionality for hoteliers.

| Type | Name | EAN |
|---------------------------|--|---------------|
| 21581 | 2" loud-speaker - 32 Ohm | 5603011557812 |
| RFMD-100 | Motion detector | 8595188150293 |
| RFWD-100 | Window detector | 8595188150279 |
| 6426 | ELKO EP LED Strips, 30LED/m - 10 cm | 8595188164269 |
| RFSTI-111B | Switch unit with a temperature sensor | 8595188149150 |
| RFSA-66M/230 V | Wireless switch, 6 functions | 8595188142823 |
| RFDA-73M/RGB | Dimmer for coloured (RGB) LED strips | 8595188146814 |
| eLAN-RF-Wi-003 | Smart box to control electroinstallation by smartphone | 8595188148726 |
| RFTC-50/G /white | Temperature regulator - extension for RF Touch | 8595188148757 |
| RFWB-40/G | Wireless switch, 4 buttons | 8595188140607 |
| LARA Intercom_white_white | Music player | 8595188149389 |
| RFJA-12B/230V | Switch unit for shutters | 8595188137010 |
| RFDEL-71B | Universal dimmer | 8595188145121 |
| RFWB-20/G | Switch, 2 inputs | 8595188140379 |
| DL SL-GU10-350-3K | LED spot dimm, dimmable, warm cold white | 8595188165563 |
| LL-G9-100-4K | LED G9 | 8595188164504 |
| RFIM-40B | Universal RF transmitter, 4 channels | 8595188137188 |
| RFIM-20B | Switch, 4 inputs | 8595188139274 |
| PSB-10-24 | Power supply | 8595188143783 |
| RF Key | 4-channel remote control in the keychain design | 8595188143752 |
| LB-E27-1060-3K | LED max - replacement wattage 75W, warm white | 8595188164733 |



| Product number | Parameters | Price |
|-------------------|------------------------------|---------|
| Code 80372 | Dimension 620 x 480 x 290 mm | 2 146 € |
| EAN 8595188157773 | Weight 7 kg | |

Case Energy Management

The Energy metering presentation case is used to demonstrate the measurement of energy in existing gauges (water, gas, and electricity) and the subsequent evaluation via the ELKO EP cloud and applications on a smartphone. The presentation case is designed especially for utilities and for demonstrations to end-customers.

| Type | Name | EAN |
|--------------|--------------------------------------|---------------|
| RFDA-73M/RGB | Dimmer for coloured (RGB) LED strips | 8595188146814 |
| RFPM-2M/230V | Energy gateway | 8595188151788 |
| RFTM-1 | Wireless pulse converter | 8595188143158 |
| ZNP-10-12V | Power supply | 8594030332733 |
| RFWB-40/G | Wireless switch, 4 buttons | 8595188140607 |
| RFDEL-71M | Universal dimmer | 8595188145121 |
| PS-30-12V | Switching power supply | 8595188137966 |
| eLAN-RF-003 | Smart RF box | 8595188148726 |

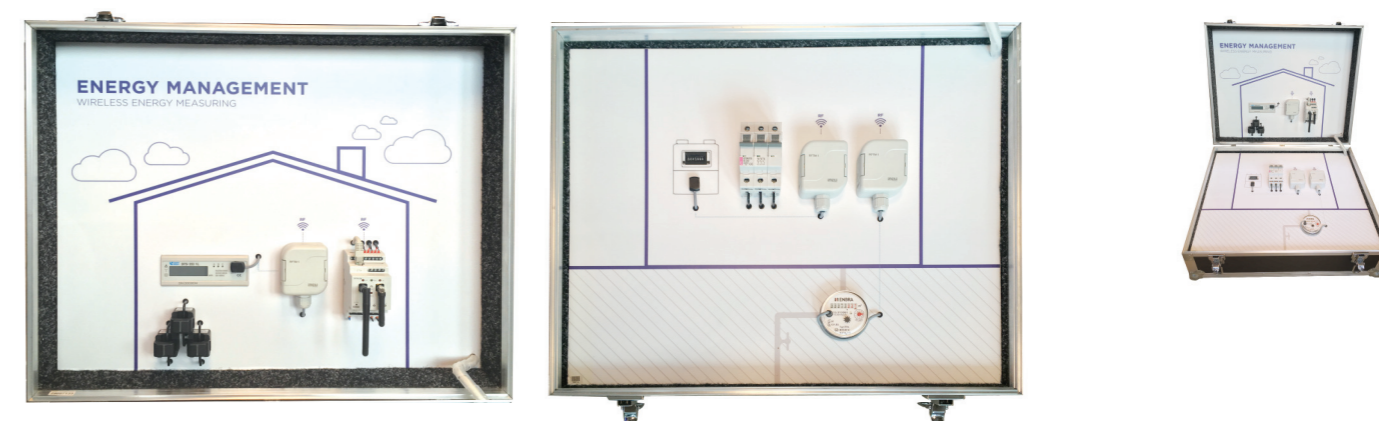

| Product number | Parameters | Price |
|-------------------|------------------------------|---------|
| Code 80379 | Dimension 609 x 406 x 216 mm | 1 685 € |
| EAN 8595188157780 | Weight 2 kg | |

Case RELAY Modular Electronic Devices

The presentation case is used to present a portfolio of modular devices (timing, twilight, dimmers, monitoring of voltage, current, thermostats, level relay ...). It is suitable for presentations, self-education and general familiarization with the products. The suitcase is packed with over fifty functional products.

| Type | Name | EAN |
|---|---|---------------|
| CRM-81J /UNI ZN-1-10min | Single function time relay | 8595188119535 |
| CRM-2H/UNI | Asymmetric cycler, output 1x16A | 8595188113007 |
| CRM-91HE /UNI + 1x external potentiometer | Multifunction time relay with external control, 10 functions, output 1x16A | 8595188142052 |
| PDR-2A /UNI | Programmable digital relay, 16 functions, output 2x16A, time 100h | 8594030333044 |
| SHT-1/2 /UNI | Time switch clock (digital) | 8595188130417 |
| SHT-4/230V | Astronomical time switch clock | 8595188144759 |
| SHT-6 + DCFR-1 | The time switch with DCF managing | 8595188148382 |
| SMR-T /230V | Super-multifunction relay, 9 functions, 3-wire connection works without NEUTRAL | 8595188129107 |
| SMR-B /230V | Super multifunction relay - 4 wire, can be switched on and fluorescent | 8595188135566 |
| CRM-4 /230V | Staircase switch, 0.5-10min., 1xoutput 16A, supply 230V | 8595188115605 |
| CRM-42F | Programmable staircase switch | 8595188146883 |
| DIM-2 /230V | Staircase switch with dimming up | 8595188135740 |
| USS-02 | Change-over switch (8A / 250V AC) | 8595188124638 |
| DIM-14 /230V | Dimmer controlled by buttons, all loads (R-L-C), 500VA | 8595188135955 |
| LIC-1 + photosensor SKS | Lighting intensity controller | 8595188144933 |
| SMR-M /230V | Dimmer for LED and dimmable energy-saving bulbs | 8595188143776 |
| SOU-1 + fotosensor SKS /UNI | Twilight switch analogue, including sensor, supply UNI | 8595188121019 |
| SOU-2 /230V + fotosenzor SKS | Twilight switch digital with time switch, supply 230V | 8595188130523 |
| SOU-3 /230V | Twilight light switch with IP65 protection, built-in light sensor | 8595188140560 |
| VS116U /RED | Power relay 1x16A, UNI | 8595188124607 |
| VS316 /230V red | Power relay 3x16A | 8595188135559 |
| DLB-E27-806-2K7 | Dimmed LED bulb, replace conventional 60W bulbs | 8595188161923 |
| VS116B/230 | Power relay 1x16A, AC 230V | 8595188147545 |
| 750L /230V AC | Power plug-in relay3x10A | 8595188119221 |
| 782L /24V AC | Power plug-in relay4x6A | 8595188119092 |
| MR-42 /UNI | Latching relay, 2xoutput 16A | 8595188115919 |
| USS-ZM | Basic module | 8595188124577 |
| USS-01 | Switch (6A / 250V AC) | 8595188124621 |
| VS425 -22 230V AC/DC | Contactora 4x25A | 8595188121675 |
| USS-04 | Switch + button with middle position (10A / 250V AC) | 8595188124652 |
| USS-14 | USS changeable module (LED red flashing) | 8595188124898 |
| USS-15 | USS changeable module (blue LED) | 8595188124379 |
| TER-3B | Thermostat | 8595188138406 |
| TER-9 /230V | Thermostat + time switch | 8595188124478 |
| TER-7 | Thermostat | 8595188137164 |
| ATV-1 | Economy digital thermo-valve | 8595188160889 |
| TC-0 | Thermo sensor 100 mm | 8595188110075 |
| TZ-0 | Thermo sensor | 8595188140591 |
| VS440 -40 230V AC/DC | Contactora 4x40A | 8595188121453 |

| | | |
|----------------------|--|---------------|
| TEV-4 | Outdoor thermostat, 3 temperatures. range -30 .. +65 ° C | 8595188140577 |
| RHT-1 | Hygrostat | 8595188137263 |
| HRH-1/230V | Level switch | 8594030337783 |
| HRH-5/UNI | Level switch | 8595188136396 |
| HRH-7 | Level switch with protection IP65 | 8595188149471 |
| SHR-1-M | Probes for level switch | 8595188110105 |
| SHR-2 | Probe for level relay | 8595188111263 |
| COS-1 /230V | Relay monitoring power factor | 8595188120906 |
| HRF-10 | Frequency monitoring relay | 8595188144827 |
| HRH-33 | Monitoring voltage relay | 8595188115636 |
| HRN-43N /230V | Monitoring voltage relay, 3-phase | 8594030338216 |
| HRN-55N | Monitoring voltage relay | 8595188137232 |
| HRN-57N | Monitoring voltage relay | 8595188137249 |
| MPS-1 | 3 phase status mains signalization | 8595188145978 |
| PRI-42/230 | Monitoring current relay | 8595188140515 |
| PRI-51/1A | Current monitoring relay | 8595188124904 |
| PRI-52 | Watch current relays, designed for remote diagnostics facilities | 8595188136556 |
| PSB-10-12 | Power supply | 8595188145022 |
| PSB-10-24 | Power supply | 8595188143783 |
| PS-30 | Switching power supply | 8595188136655 |
| PS-100-24V | Switching power supply | 8595188139021 |
| ZSR-30 | Power supply | 8594030331750 |
| ZTR-8-8 | Bell transformer | 8595188136808 |
| VS220 -20 230V AC/DC | Contactora 2x20A | 8595188121392 |
| VS425 -31 230V AC/DC | Relay, Contactora 4x25A | 8595188121668 |
| VSM220-20 230V | Relay, contactora with manual control 2x20A | 8595188128087 |
| PRI-53/5 | Three phase relay 5A | 8595188142144 |
| VS420 -40 230V AC | Relay, Contactora 4x20A | 8595188121439 |

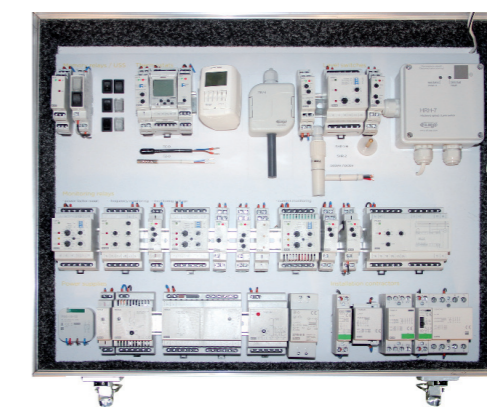
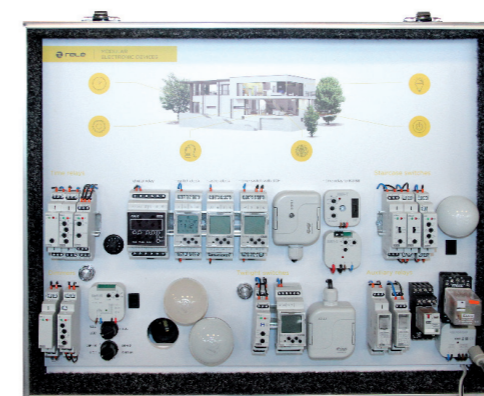

| Product number | Parameters | Price |
|-------------------|------------------------------|---------|
| Code 80380 | Dimension 620 x 480 x 290 mm | 1 274 € |
| EAN 8595188157797 | Weight 10 kg | |

Case BUS & Wireless & Multimedia

The iNELS presentation case is a comprehensive tool for presenting iNELS. It is a combination of bus and iNELS including wireless multimedia extensions IMM and demonstrating compatibility with third parties. The case is suitable for system partners presenting in exhibitions but also as a training tool.

| Type | Name | EAN |
|-------------------|---|---------------|
| CU3-01M | Central unit | 8595188132220 |
| 90920 Crystal TCA | Double-frame, CRYSTAL (glass) | 5603011554002 |
| 90930 Crystal TCA | Triple-frame, CRYSTAL (glass) | 5603011554019 |
| 90652 TBR | Socket cover | 5603011064396 |
| TOUGH Switch | PoEPro 8x bit LAN, 24V/48V | 8595188166065 |
| BPS3-02M | Bus separator from power supply | 8595188132435 |
| SA3-06M | Switching actuator 6-fold | 8595188132879 |
| DA3-22M | Dimming actuator | 8595188132626 |
| EMDC-64M | iNELS-dali/dmx converter | 8595188150309 |
| DAC3-04B | Digital-analog converter | 8595188132572 |
| IM3-40B | Binary inputs unit | 8595188132312 |
| WSB3-20 | 2 buttons controller | 8595188132343 |
| WSB3-40 | 4 buttons controller | 8595188132336 |
| 21154 | Double-button (2NO+2NC) | 5603011580643 |
| EST3 | Control touch unit, mounting into an installation box, Logus ⁹⁰ design | 8595188177009 |
| GSB3-40 | Wall glass touch controller | 8595188132909 |
| RFSA-62B/230 | Switch 6 functions | 8595188142816 |
| RFDEL-71B | Dimming actuator for dimming LED bulbs and dimmable energy saving lamps | 8595188145121 |
| RFWB-40/G | Wireless switch, 4 buttons | 8595188140607 |
| RFDA-73M | Dimming actuator to dim an LED strip and RGB LED strip | 8595188146814 |
| DLSL-GU10 | Dimmable LED spot, base type GU10, 6W | 8595188163422 |
| LED strips | LED strips, 14,4W, WHITE, 60LED/m - 1m | 8595188163316 |
| RFWB-40/G | Wireless switch, 4 buttons | 8595188140607 |
| RFDA-73M | Dimming actuator to dim an LED strip and RGB LED strip | 8595188146814 |
| DLSL-GU10 | Dimmable LED spot, base type GU10, 6W | 8595188163422 |
| LED strips | LED strips, 14,4W, WHITE, 60LED/m - 1m | 8595188163316 |
| 90450 SAL | Data socket RJ45 2 outputs (without connectors) | 5603011070557 |
| LSL-GU10-350-3K | LED spot max, replacement wattage 50W, warm white | 8595188164191 |



Case BUS & Wireless & Multimedia

| Type | Name | EAN |
|------------------|---|---------------|
| iMM Client | Player videozone allowing control od all system functions through the TV screen | 8595188149334 |
| iMM Audio Zone-R | Audiozone player | 8595188150125 |
| LARA_intercom | Video Intercom for easy communication | 8595188149372 |
| eLAN-IR-003 | Smart IR Box | - |
| eLAN-RF-003 | Smart box for controlling audio-video devices through your smartphone | 8591881468845 |
| AXIS M5014 | IP camera AXIS | 7331021034464 |
| Cool Mater | Control unit for air-conditioning | 8595188162043 |
| 2N Helios | Door communicator | 859515959844 |
| LARA radio | Your Internet Radio in the switch | 8595188151313 |

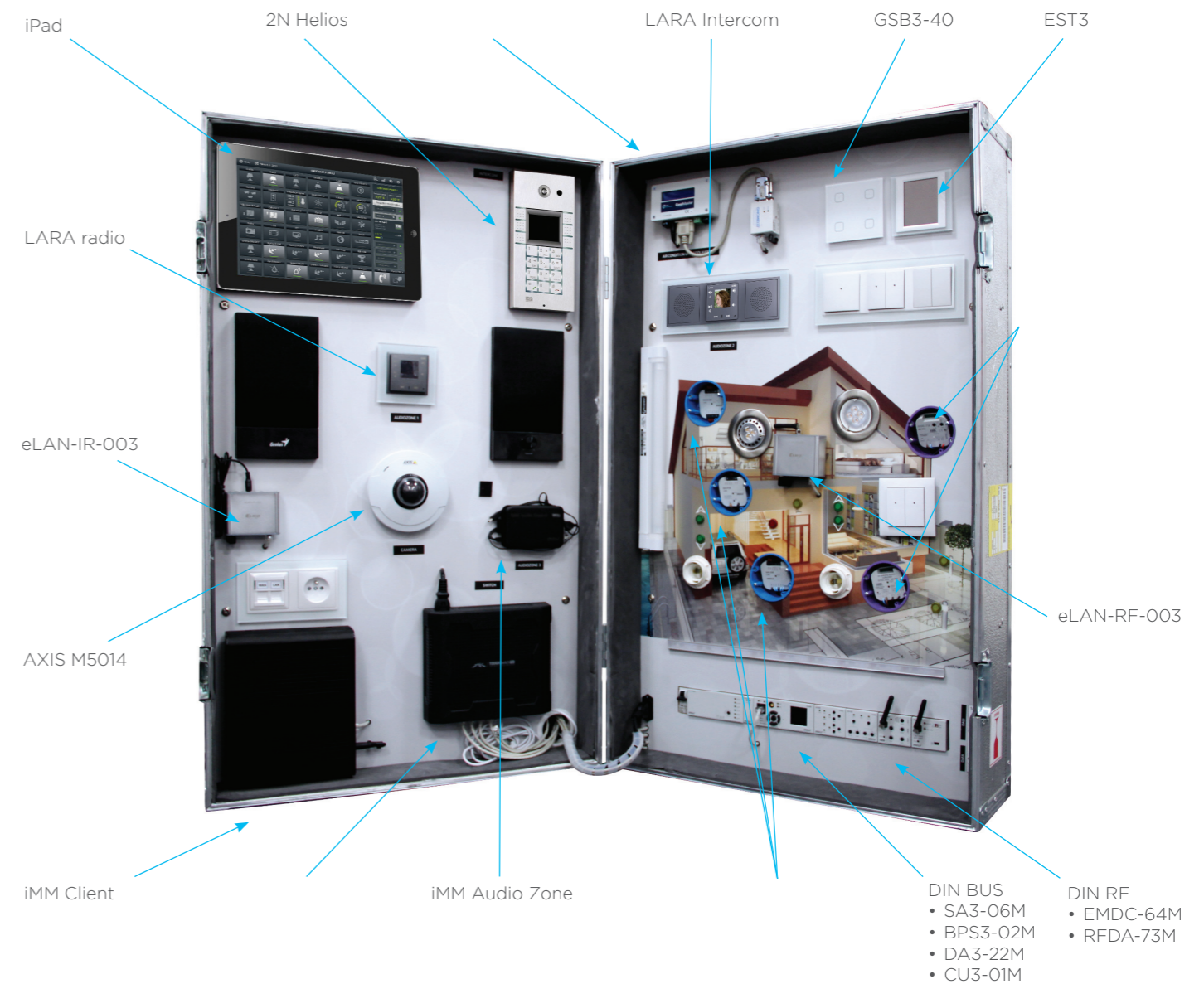

| Product number | Parameters | | Price |
|----------------|---------------|-----------|----------------------|
| Code | 80295 | Dimension | 1 015 x 615 x 370 mm |
| EAN | 8595188174039 | Weight | 52 kg |

Case Dimming solution (we can dimm all)

| Type | Name | |
|--------------------|---|---------------|
| RFSA-66M/230V | Wireless switch, 6 functions | 8595188142823 |
| RFDSC-71_French | Dimming socket, singlefunction, French type | 8595188145923 |
| LED STRIP | LED strips, 14,4W, RGB, 60LED/m - 5 cm | 8595188164306 |
| LED STRIP | LED strips, 14,4W, WARM WHITE, 60LED/m - 5 cm | 8595188164313 |
| LIC-1 | Lighting intensity controller | 8595188144933 |
| RFDA-73M/RGB | Dimming actuator to dim an LED strip and RGB LED strip | 8595188146814 |
| RFDEL-71B | Dimming actuator for dimming LED bulbs and dimmable Energy Saving Lamps | 8595188145121 |
| RFDAC-71B | Actuator with analog output 0(1)-10V | 8595188142809 |
| GSB3-40 | Wall glass touch controller | 8595188132909 |
| PS-100-12V | Switching power supply | 8595188137195 |
| LP-6060-2300-5K7 | LED panel, 595x595mm, cool white, the ceiling panel | 8595188162005 |
| LED spot dimm GU10 | LED spot dimm GU10 | 8594030337288 |
| e-LAN-RF-003 | Converter Ethernet | 8591881468845 |
| LL-G9-100-4K | LED bulb in a G9 socket | 8595188164504 |
| DLSL-GU10-250-3K | Dimmable LED spot, base type GU10, 6W | 8595188163422 |
| LC-E14-250-3K | LED bulb, warm white 25W refund bulb classical | 8595188161947 |
| RF TOUCH-B | Wireless touch unit - for surface mounting | 8595188177504 |
| RFWB-40/G | Wireless switch, 4 buttons | 8595188140607 |
| RF Pilot/A | Wireless remote controller | 8595188145169 |
| RF Key/White | 4-channel remote control in the keychain design, white | 8595188143332 |
| LED spot dimm GU10 | LED spot dimm GU10 | 8594030337288 |



| Product number | Parameters | Price |
|-------------------|------------------------------|---------|
| Code 80266 | Dimension 730 x 320 x 210 mm | 1 362 € |
| EAN 8595188174046 | Weight 14 kg | |

Case LARA Design

Serves to demonstrate LARA as a player, Internet radio, 'intercom' for calling each other " or as a display unit for entry phones. Part of the case also shows the NAS as a music storage and smartphone control via the application. It demonstrates the connections that LARA can form (wire, wireless) and variants of speakers. The case is designed as a system partner demonstrator for customers as well as for exhibitions relating to audio / video.



RADIO



MUSIC



VIDEO DOOR-PHONE



INTERCOM



AUDIOZONE

| Type | Name | Type | Name |
|-----------|-------------------------------|-----------|--------------------------------------|
| 90910 TBR | Single-frame, BASE (plastic) | 90910 TGA | Single-frame, granite / aluminium |
| 90910 TMF | Single frame Ivory | 99626 TAL | TAL -Aluminium |
| 90910 TPE | Single frame Ice | 99626 TBR | TBR - white |
| 90910 TGE | Single frame Pearl | 99626 TGE | TGE - Ice |
| 90910 TAL | Single frame Aluminium | 99626 TIS | TIS - grey |
| 90910 TIS | Single frame grey | 99626 TMF | TMF - Ivory |
| 90910 TBB | Single frame white / white | 90910 EEC | Single frame black glass / pear |
| 90910 TMM | Single frame ivory / ivory | 90910 EED | Single frame black glass / ice |
| 90910 TTP | Single frame Titanium / Pear | 90910 EEE | Single frame black glass / aluminium |
| 90910 TUS | Single frame Aluminium / grey | 90910 EEF | Single frame black glass / grey |
| 90910 TEE | Single frame ice / ice | 90910 TCG | Single frame glass / ice |
| 90910 TPP | Single frame pearl / pearl | 90910 TCP | Single frame glass / pear |
| 90910 TQS | Single frame nickel / grey | 90910 TCS | Single frame glass / grey |
| 90910 TZG | Single frame blue / ice | 90910 TSS | Single frame grey / grey |
| 90910 TAS | Single frame Aluminium/Gray | | |



| Product number | Parameters | Price |
|-------------------|------------------------------|-------|
| Code 80365 | Dimension 340 x 440 x 105 mm | 222 € |
| EAN 8595188157803 | Weight 2,6 kg | |

Case LARA

This demo case is intended for the presentation and demonstration of LARA functionality – LARA as an internet radio, LARA as a music player, LARA as a home intercom, LARA as a home videophone (with IP door phone 2 N) and LARA as an iNELS audio zone. Thanks to the speakers designed for installation in ceilings or into switches you can enjoy the ultimate music experience.

| Type | Name |
|-----------------------------|--|
| 75023 CBR | Ceiling speaker |
| PoE supply | Set to wire LARA connection into an installation box an external adapter |
| PoE supply + WiFi into box | Set for wireless connection into an installation box |
| PoE supply into a box | Set for wire LARA connection into an installation box |
| PoE switch | Power supply for up to 5 devices |
| BeFo 511 | Door lock BeFo 511 |
| 21031 | Card switch |
| 90731 TIS | Cover of card switch |
| 90910 TBS | Single frame |
| WMR2-11/G | Wall card reader |
| LARA Radio <i>white</i> | LARA Intercom |
| 21581 | LARA Intercom |
| LARA Radio <i>aluminium</i> | LARA Intercom |
| LARA Radio <i>grey</i> | LARA Intercom |
| MK | Magnetic RFID card for WMR card reader |



| Product number | Parameters | Price |
|----------------|------------------------------|---------|
| Code 80326 | Dimension 620 x 480 x 240 mm | 3 046 € |
| EAN — | Weight 17 kg | |

Case Logus Animato

Intended for training. Demo case presenting the luxurious design of the LOGUS90 frame is intended especially for end users to choose colors, design and shape that suit interiors.

| Type | Name | EAN |
|-----------|--|----------------|
| 21011 | One-pole switch, type 1 | 5603011044589 |
| 90910 TBR | Frame design series Base (BR - White) | 5603011063146 |
| 90910 TMF | Frame design series Base (MF - Ivory) | 5603011063153 |
| 90910 TGE | Frame design series Aquarella (GE - Ice) | 5603011067861 |
| 90910 TPE | Frame design series Aquarella (PE - Pearl) | 5603011067878 |
| 90910 TAL | Frame design series Aquarella (AL - Aluminum) | 5603011067885 |
| 90910 TIS | Frame design series Aquarella (IS - Gray) | 5603011067854 |
| 90910 TCG | Frame design series Crystal (CG - Glass/Ice) | 5603011555962 |
| 90910 TTP | Frame design series Metallo (TP - Titanium/Pearl) | 56030115530951 |
| 90910 TFP | Frame design series Arbore (FP - Beech/Pearl) | 5603011553999 |
| 90910 TGG | Frame design series Petra (GG - Granite/Ice) | 5603011554033 |
| 90910 TBB | Frame design series Animato (BB - White/White) | 5603011592028 |
| 90910 TMM | Frame design series Animato (MM - Ivory/Ivory) | 5603011594251 |
| 90910 TRG | Frame design series Animato (RG - Granite/Ice) | 5603011592035 |
| 90910 TDG | Frame design series Animato (DG - Green/Ice) | 5663011592042 |
| 90910 TJG | Frame design series Animato (JG - Orange/Ice) | 5603011592073 |
| 90910 TEE | Frame design series Animato (EE - Ice/Ice) | 5603011592080 |
| 90910 TPP | Frame design series Animato (PP - Pearl/Pearl) | 5603011592097 |
| 90910 TTS | Frame design series Animato (TS - Brick/Gray) | 5603011592141 |
| 90910 TBS | Frame design series Animato (BS - Wine/Gray) | 5603011592134 |
| 90910 TAA | Frame design series Animato (AA - Aluminum/Aluminum) | 5603011592103 |
| 90910 TAS | Frame design series Animato (AS - Aluminum/Gray) | 5603011592127 |
| 90910 TSS | Frame design series Animato (SS - Gray/Gray) | 5603011592110 |

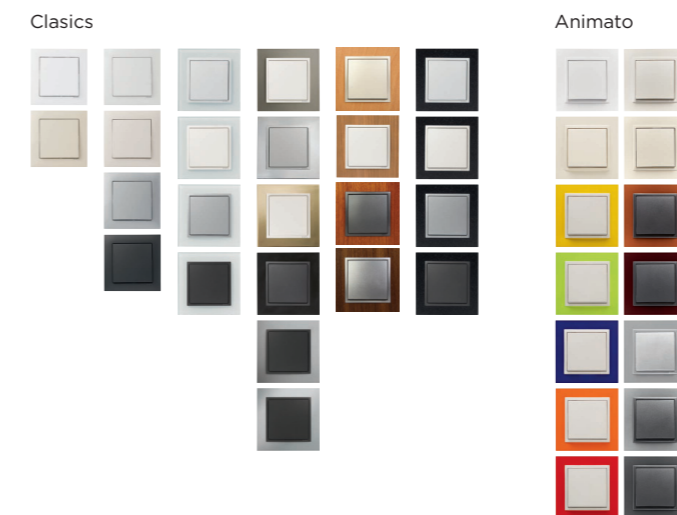

| Product number | Parameters | Price |
|-------------------|------------------------------|-------|
| Code 90909 | Dimension 340 x 440 x 105 mm | 55 € |
| EAN 5603011581466 | Weight 2,2 kg | |

Energy management – wireless energy measuring

Multilanguage (sliding labels), floor standing, can be a part of the set of boards.

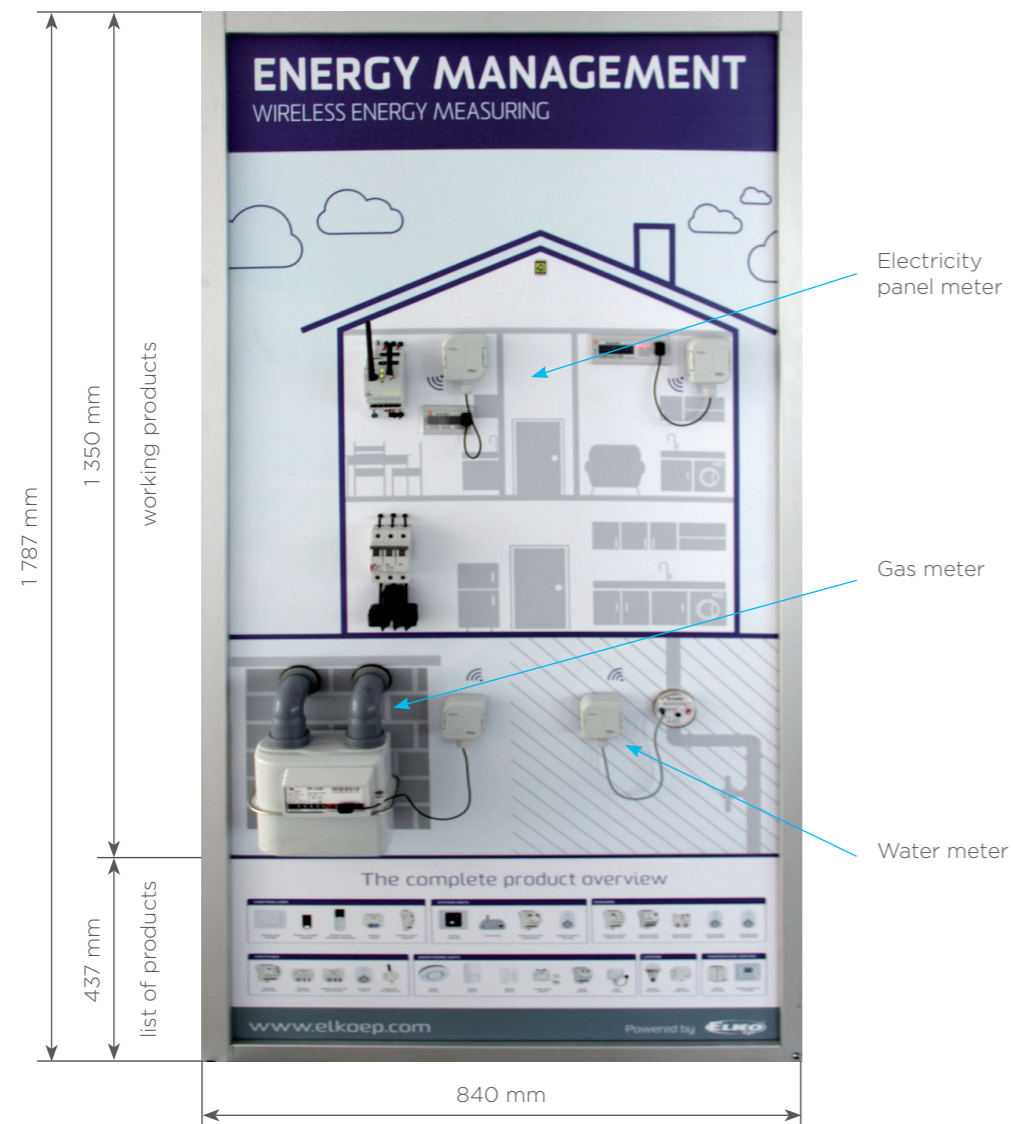

| Type | Name |
|---------|---------------------|
| RFPM-2M | Energy gateway |
| RFTM-1 | Pulse converter |
| CT50 | Current transformer |
| LS | LED sensor |
| MS | Magnetic sensor |
| IRS | Infra Red sensor |

| Product number | Parameters | Price |
|----------------|------------------------------|---------|
| Code 80364 | Dimension 1787 x 840 x 80 mm | 1 662 € |

iNELS Wireless

Multilanguage (sliding labels), floor standing, can be a part of the set of boards.

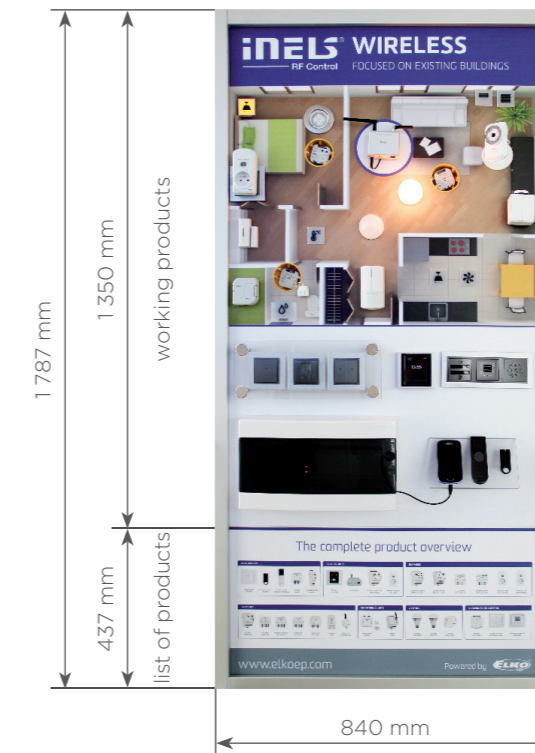

| Type | Name |
|--------------------------------------|---|
| DLSL-GU10-350-3K | LED spot dimm, dimmable, warm cold white |
| RF-RGB-LED-550 | RGB LED bulb iNELS RF Control |
| iNELS Cam | Interior color camera |
| RFSC-61_Schuko | Switching socket, multifunction, Schuko type |
| 90910 METALLO TUS - aluminium / grey | Single-frame, METALLO (metal) |
| 90631 TIS - metallic grey | Schuko socket cover |
| RFDEL-71B | Dimming actuator for dimming LED bulbs and dimmable Energy Saving Lamps |
| eLAN-RF-Wi-003_2,4GHz | Smart box to control electroinstallation by smartphone |
| RFJA-12B/230 V | Blinds RF actuator |
| FP-1 | Flood probe |
| RFSF-1B | Wireless flooding sensor |
| RFSOU-1 | Twilight / light switch |
| RFATV-1 | Wireless thermostatic valve |
| RFTC-10/G /grey | Temperature regulator - extension for RF Touch |
| 99601 TIS - grey | Cover for RFWB-20/G, WSB2-20/G, WTC2-21/G and WMR2-11/G |
| LARA-IC/IS | LARA Intercom |
| 99611 tis - grey | Cover for RFWB-40/G and WSB2-40/G |
| RF Touch-W_nickel/ white white | Wireless touch unit - for surface mounting |
| 90930 METALLO TUS - aluminum / gray | Triple-frame, METALLO (metal) |
| 90601 TIS - metallic grey | Rocker plain |
| 90910 TUS | Single-frame, CRYSTAL |
| RFWD-100 | Window detector |

| | |
|-----------------------------------|--|
| RF Pilot/A | Wireless remote controller |
| RF Key/B black | 4-channel remote control in the keychain design, black |
| Samsung i8200 Galaxy SIII mini VE | Smart phone |
| RFSA-66M /230 V | Switching actuator, 6 independent channels, 3x8A NO, 3x8A CO |
| RF GSM-220 | Multifunction GSM communicator |
| RFSTI-11/G/ aluminium | Switching actuator with in-built thermosensor and thermo input |
| RFMD-100 | Motion detector |
| PS-30-24V | Power supplies |
| RFSTI-11/G_grey | Switching actuator with in-built thermosensor and thermo input |
| RFSA-62B /230V | Wireless switch unit (inbuilt) - 2 outputs |

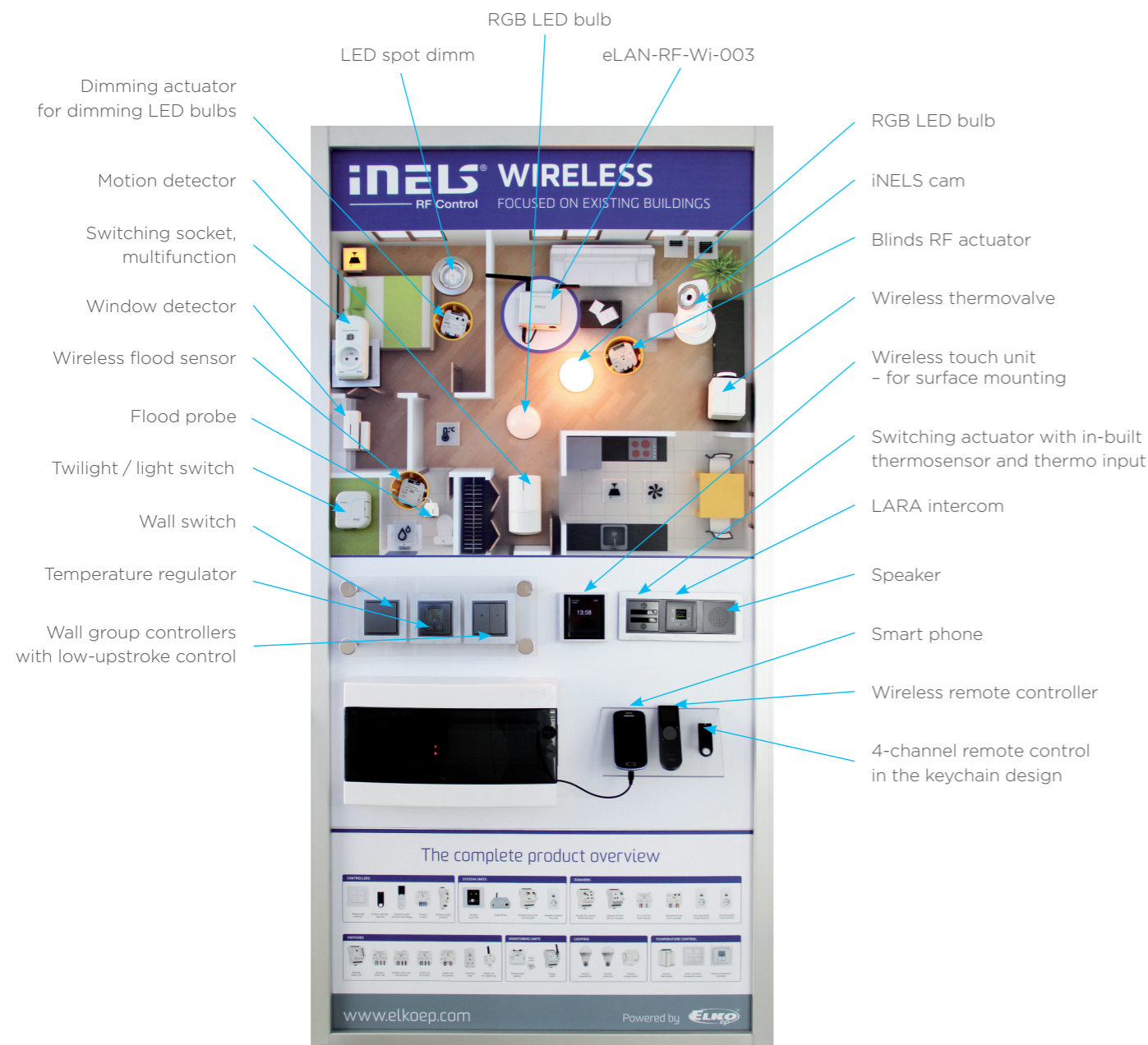

| Product number | Parameters | Price |
|----------------|-------------------------------|---------|
| Code 80339 | Dimension 1 787 x 840 x 80 mm | 1 583 € |

iNELS III BUS

Neutral language (sliding labels), floor standing, can be a part of the set of boards.

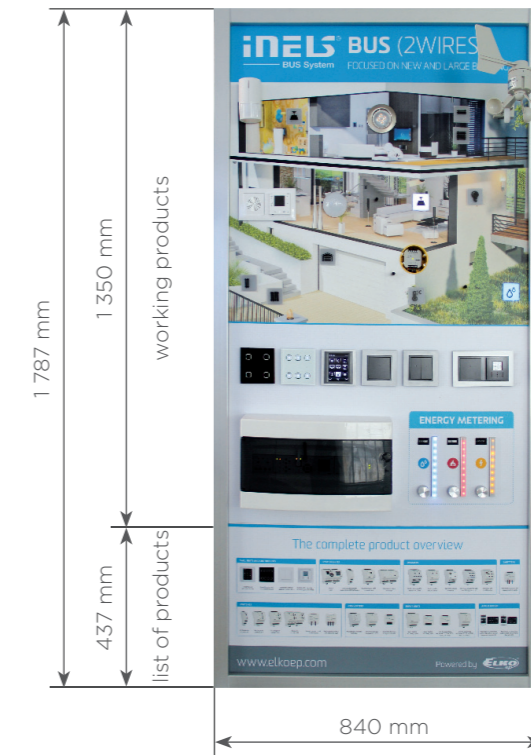

| Type | Name |
|-------------------|--|
| DL SL-GU10-350-3K | LED spot dimm, dimmable, warm cold white |
| Giom 3000 | Weather stations GIOM 3000 |
| 2" Loud-speaker | For mounting into an installation box |
| 90920 TBR | Double-frame, BASE (plast) |
| 90910 TBR | Single-frame, BASE (plast) |
| LARA radio | Music in your switch |
| RF-RGB-LED-550 | RGB LED bulb iNELS RF Control |
| TC-3 | Thermo sensor |
| TI3-40B | For connecting temperature sensor TC, TZ, Ni1000, Pt1000 or Pt100 |
| GSB3-40 /B black | 4 chanel glass wall touch controller |
| GSB3-60 /white | 6 chanel glass wall touch controller |
| EST3 | Control unit with touch screen - aluminum/metalic grey |
| 90910 METALLO TUS | Single-frame, METALLO (metal) - aluminium /grey |
| 99601 TIS - grey | Cover for RFWB-20/G, WSB2-20/G, WTC2-21/G and WMR2-11/G |
| 99611 TIS - grey | Cover for RFWB-40/G and WSB2-40/G |
| 90920 TUS | Double-frame, METALLO (metal) - aluminum / gray |
| D-Link GO-RT-N150 | Camera D-Link |
| BPS2-01M | Bus separator from power supply |
| CU3-02M | Brain of iNELS system with RF interface |
| PS3-100/iNELS | Switching regulated power supply with total power IN AC 100 - 250 V AC |
| BPS3-02M | For the impedance separation of one CIB line from the power supply |

| | |
|-------------------|---|
| SA3-06M | For switching home appliances, e.g. lighting and thermo drivers |
| DA3-22M | For dimming ESL, LED and RLC load |
| IM3-80B | Binary inputs, 8x binary inputs, 12 V DC/75 mA, box |
| Connection server | Connection between iNELS BUS system units and another devices |
| PoE supply | Power supply for weather stations GIOM 3000 |
| RFWB-20/G | RF transmitter, 2 channels |
| RFWB-40/G | RF transmitter, 4 channels |
| WSB3-20 | Wall group controllers with low-upstroke control |
| IDRT3-1 | For correction of heating / cooling |
| MI3-02M/iNELS2 | Allows you to extend the number of connected peripheral iNELS units |
| RFSA-61M/230 V | Switching RF actuator with internal antenna - 6 functions, 1x switching 16A |

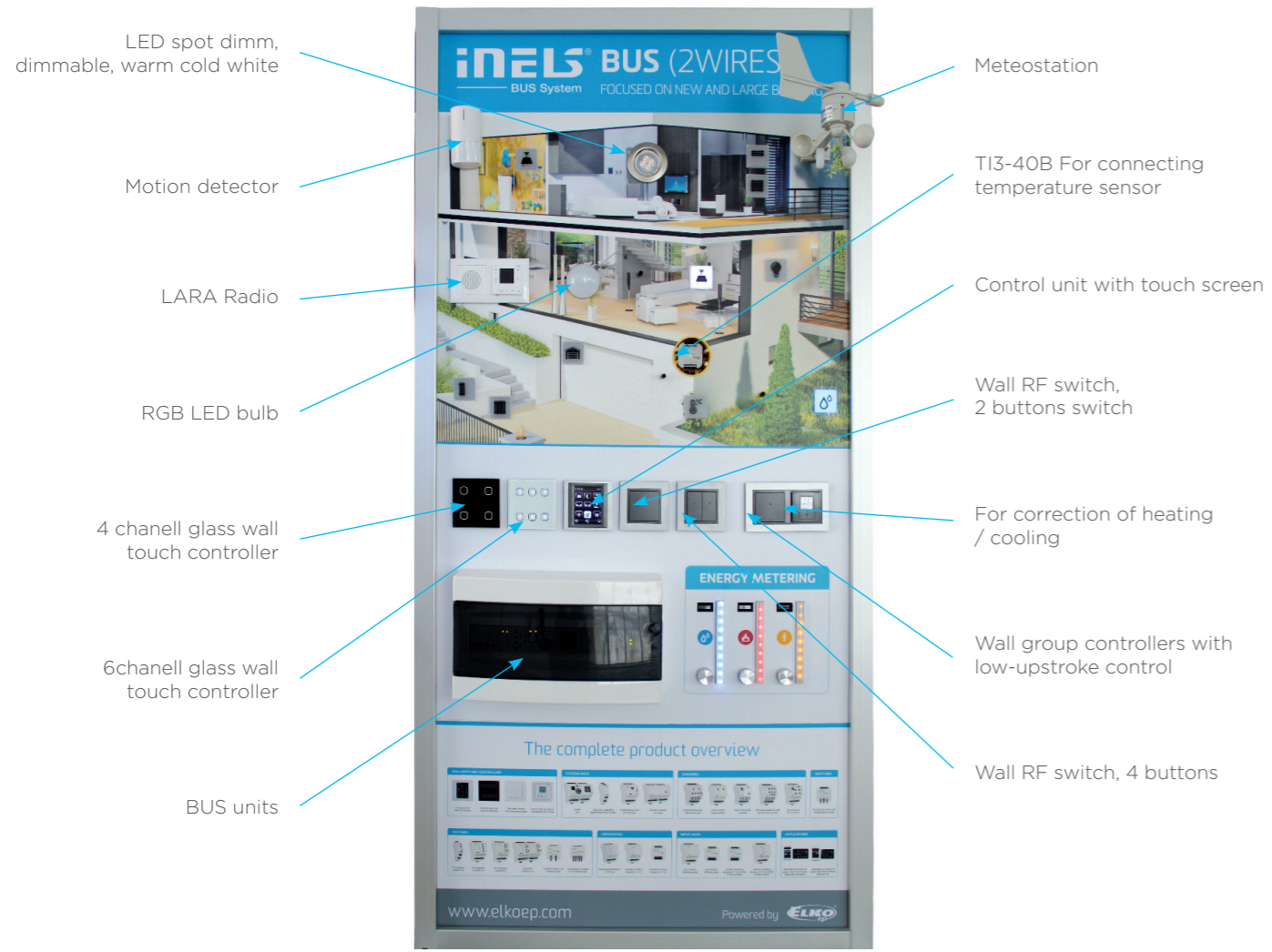

Smart House Full (5 x 3 m)

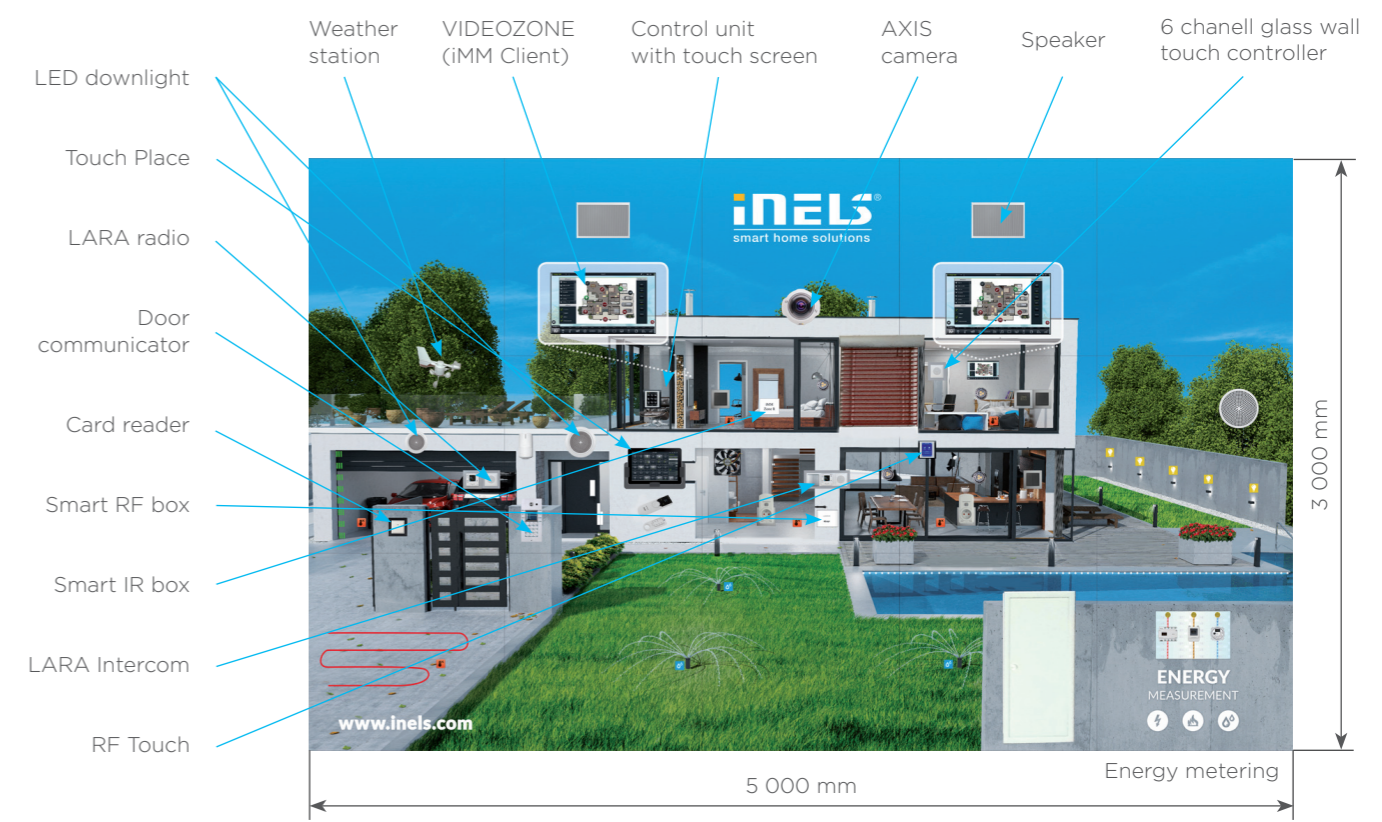

Smart House Board

Parameters

- 1 000 x 1 000 mm
- 2 000 x 2 000 mm
- 3 000 x 3 000 mm
- 4 000 x 3 000 mm
- 5 000 x 3 000 mm



| Product number | Parameters | Price |
|----------------|-------------------------------|---------|
| Code 80340 | Dimension 1 787 x 840 x 80 mm | 1 782 € |

Smart House Full (5 x 3 m)



Construction nets (3 x 5m)

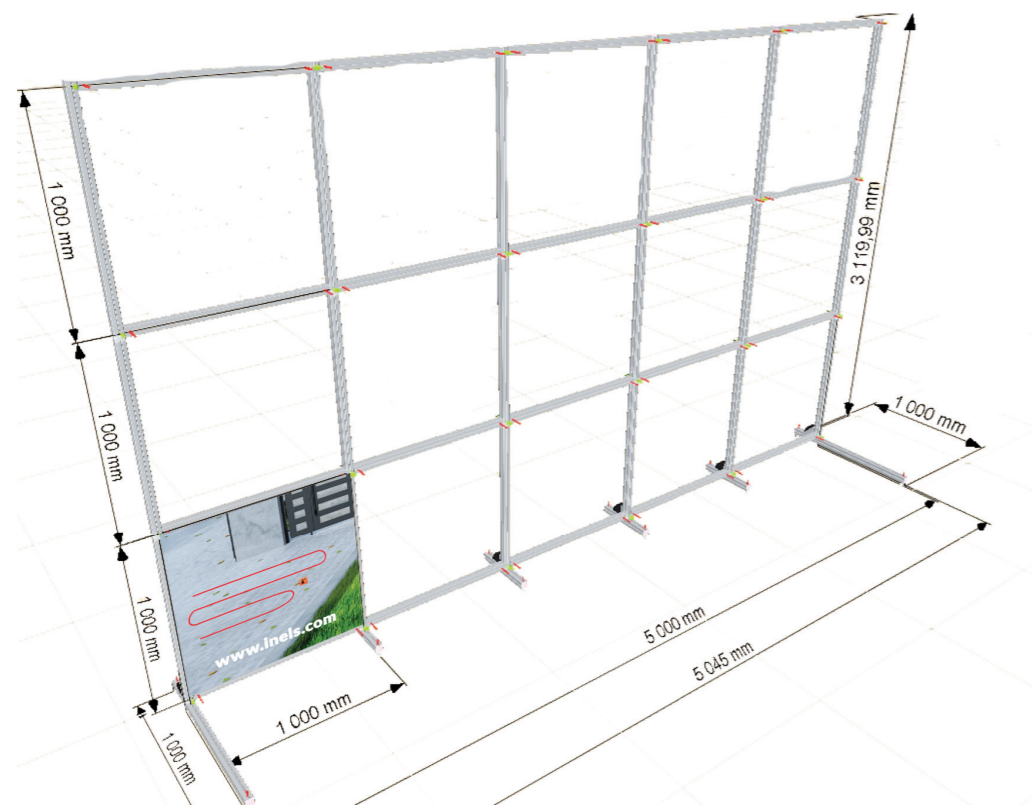

Smart House Full (5 x 3 m)

| Type | Name | Type | Name |
|--------------------|--|-----------------|--|
| 21581 | For mounting into an installation box | Energy metering | Energy metering |
| LARA speaker cable | Patch cable LARA - speaker | PS-100-12V | Switching power supply |
| 90632 TPE | Schuko socket cover | RFDCS-71_Schuko | Dimming socket multifunction, Schuko type |
| 21131 | Socket Schuko | SA3-06M | For switching home appliances |
| Tab3 P5210 | Samsung Galaxy Tab3 P5210, 10.1" 16GB | RF Pilot | Wireless remote controller |
| TL-WR743ND | TP-LINK router | RF Key | 4-channel remote control in the keychain design |
| LARA power adapter | Power adapter 12V, 1A, 12W | BPS2-01M | Bus separator from power supply |
| 90910 TUS | Single-frame | 99611 TPE | Cover for RFWB-40/G and WSB2-40/G |
| BeFo 511 | Door lock | 90910 TTP | Single-frame, METALLO |
| 21581 | For mounting into an installation box | JA2-02B/DC | Shutter actuator |
| IDRT3-1 | For correction of heating / cooling | CU3-01M | Brain of iNELS system |
| 99611 TIS | Cover for RFWB-40/G and WSB2-40/G | DA3-22M | For dimming ESL, LED and RLC load |
| LG 23LED IPS237L | TV monitor LG | LED strips | LED strips, 14,4W, RGB, 60LED/m-1m |
| DLSL-GU10-350-3K | DLSL-GU10-350-3K | LL-G9-100-4K | LED G6 |
| MK RFID | Magnetic RFID card for WMR card reader | RFWB-40/G | Wall RF switch, 4 buttons |
| WMR2-11/G | WALL card reader | AXIS | AXIS 212 PTZ |
| DL-95-450-3K | LED Downlight | EST-3 | Control unit with touch screen |
| FR TOUCH-W | Wireless touch unit for surface mounting | Giom 3000 | Meteostation |
| GSB3-60 | 6 channel glass wall touch controller | Card reader | Card reader |
| LARA radio | Music in your switch | TOUCH PLACE | Tablet |
| IP Door phone | 2N Helios IP Vario, 3x2 button + camera | eLAN-RF-003 | Converter Ethernet |
| WSB3-20 | Wall group controller with low-upstroke control | WSB3-40 | Wall group controllers with low-upstroke control |
| RFSC-61_Schuko | Switching socket, multifunction, Schuko type | RFTC-50/G/IS | Temperature regulation - extension for RF Touch |
| eLAN-IR-003 | Smart box for controlling audio-video devices through your smartphone | | |
| iMM Client | Player videozone allowing control of all system functions through the TV screen | | |
| IM3-40B | To connect up to 2/4 devices with potential-free contact | | |
| 99601 TGE | Cover for RFWB-20/G, WSB2-20/G, WTC2-21/G and WMR2-11/G | | |
| PS3-100/iNELS | Switching regulated power supply with total power 100 W | | |
| PBS3-01M | For the impedance separation of one CIB line from the power supply | | |
| RFSA-66M/230V | Switching actuator, 6 independent channels, 3x8A NO, 3x8A CO | | |
| RFDA-73M | Dimming actuator to dim an LED strip and RGB LED strip | | |
| LARA intercom | Your Video Intercom for easy communication | | |
| 75106 CBR - white | 2-way speaker for mounting on the wall or for ceiling mounting | | |
| MI3-02M/iNELS S2 | Allows you to extend the number of connected peripheral iNELS units | | |
| DL-122-800-3K | To the ceiling for downlight assembly, mounting hole average 122 mm, depth 60 mm | | |
| SA3-02B | For switching home appliances and controlling shutters/blinds | | |
| RFDEL-71B | Dimming actuator for dimming LED bulbs and dimmable Energy Saving Lamps | | |

| Product number | Parameters | Price |
|----------------|-------------------------------|----------|
| Code 80324 | Dimension 5000 x 3000 x 10 mm | 11 538 € |

Shipping boxes for panel

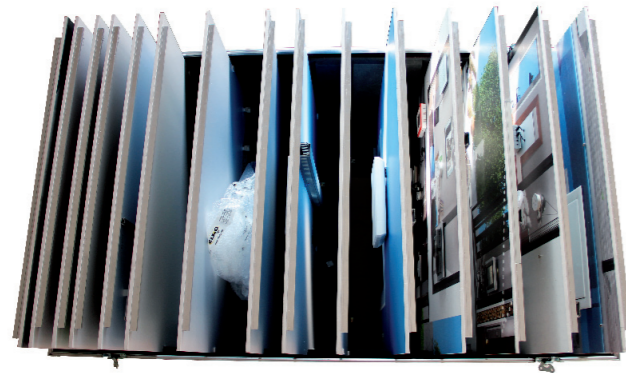

Shipping boxes for profiles and construction



Panel AUDIO/VIDEO

Neutral language (sliding labels), floor standing, can be a part of the set of boards.

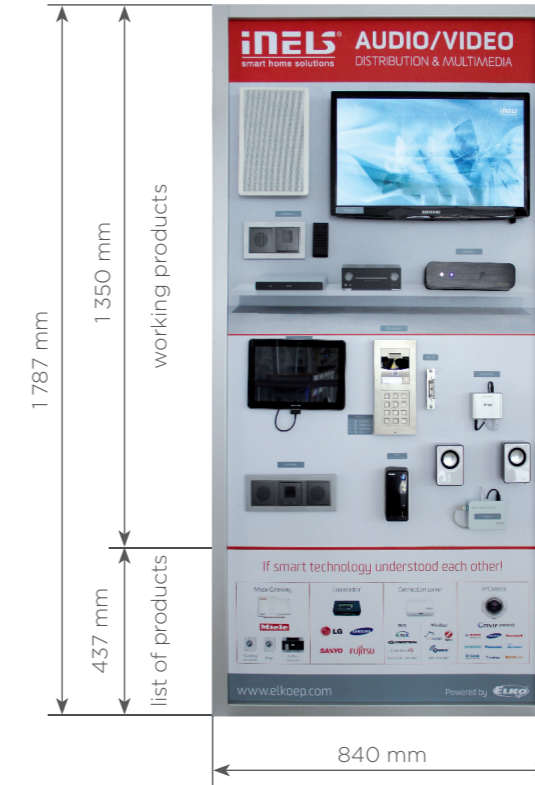

| Type | Name |
|----------------------|---|
| LARA speaker cable | Patch cable LARA - speaker |
| 21581 | For mounting into an installation box |
| LARA-R/IS | LARA Radio cover - grey without frame |
| LARA-R/IS/TAS | LARA Radio cover - aluminium |
| 90930 TUS | Triple-frame, METALLO (metal) |
| iMM Client | Player videozone allowing control of all system functions through the TV screen |
| Tablet | Tablet Samsung P7500 Galaxy |
| Door communicator | 2N Helios IP Verso |
| BEFO 1221 | Door lock |
| AXIS M5014 | IP camera AXIS |
| LARA PoE adapter | Power supply for one device |
| PoE Switch - 8x RJ45 | Power supply for up to 8 devices |
| VS116U | Power relay 1x16A, UNI |
| Genius SP-Q120 | Repro Genius SP-Q120 black |
| iMM Audio Zone-R | Audiozone player |
| e-LAN-IR-003 | Smart box for controlling audio-video devices through your smartphone |

Panel AUDIO/VIDEO

Neutral language (sliding labels), floor standing, can be a part of the set of boards.

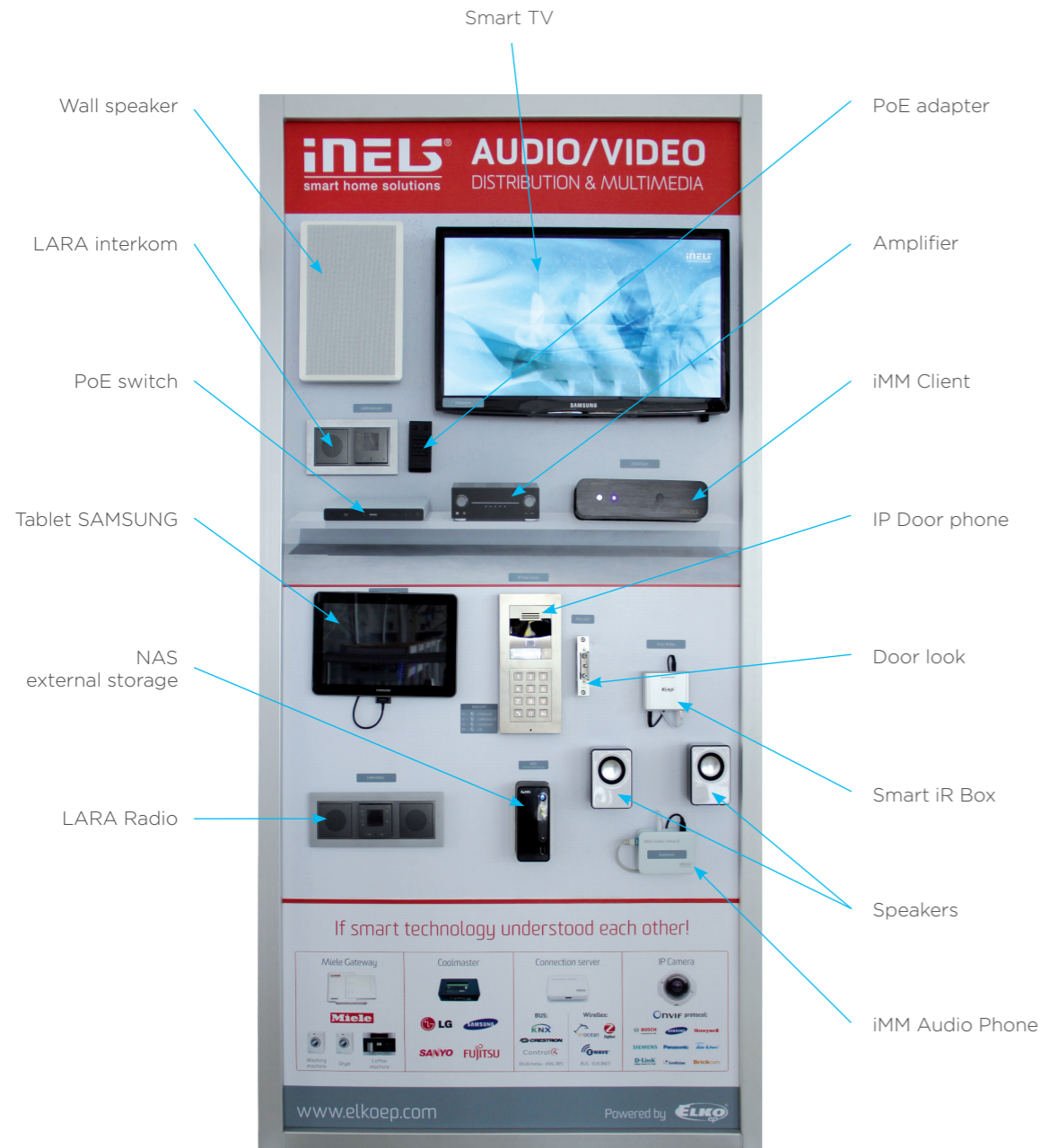

Panel LOGUS⁹⁰ Home switches & sockets

Neutral language (sliding labels), floor standing, can be a part of the set of boards.

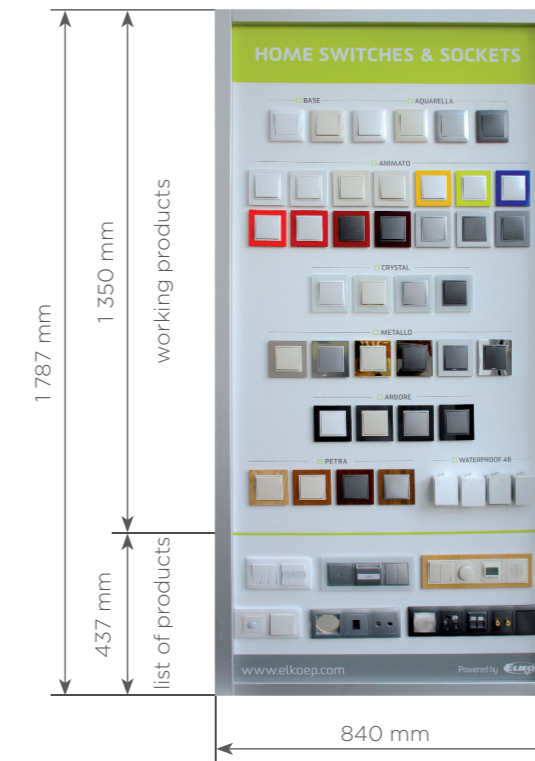

| Product list | Specification |
|--------------|--|
| BASE | Smart finish. Discrete shape of function. |
| AQUARELLA | Distinct colors. Shades that characterize the space. |
| ANIMATO | Large selection of colors, modern design and pleasant price. |
| CRYSTAL | Brightness and clarity. Shades that bring the shine of crystals into a honed experience. |
| METALLO | Distinction and modern feel. The refinement and brightness of metal enhance the value of the surroundings, and lend inspiration to great moments. |
| ARBORE | Selection of natural materials. Warm shades of wood with their varying structures create a room full of happiness and sincere comfort. |
| PETRA | The beauty and stability of nature. Stone with its uneven patterns, shaped by time and nature, represent the sense of firm and unending existence. |

| Product number | Parameters | Price |
|----------------|-----------------------------|---------|
| Code 80341 | Dimension 1787x 840 x 80 mm | 4 431 € |

| Product number | Parameters | Price |
|----------------|------------------------------|-------|
| Code 80271 | Dimension 1787 x 840 x 80 mm | 646 € |

RELAY display (Dimmers & thermostats)

Neutral language (sliding labels), floor standing, can be a part of the set of boards.

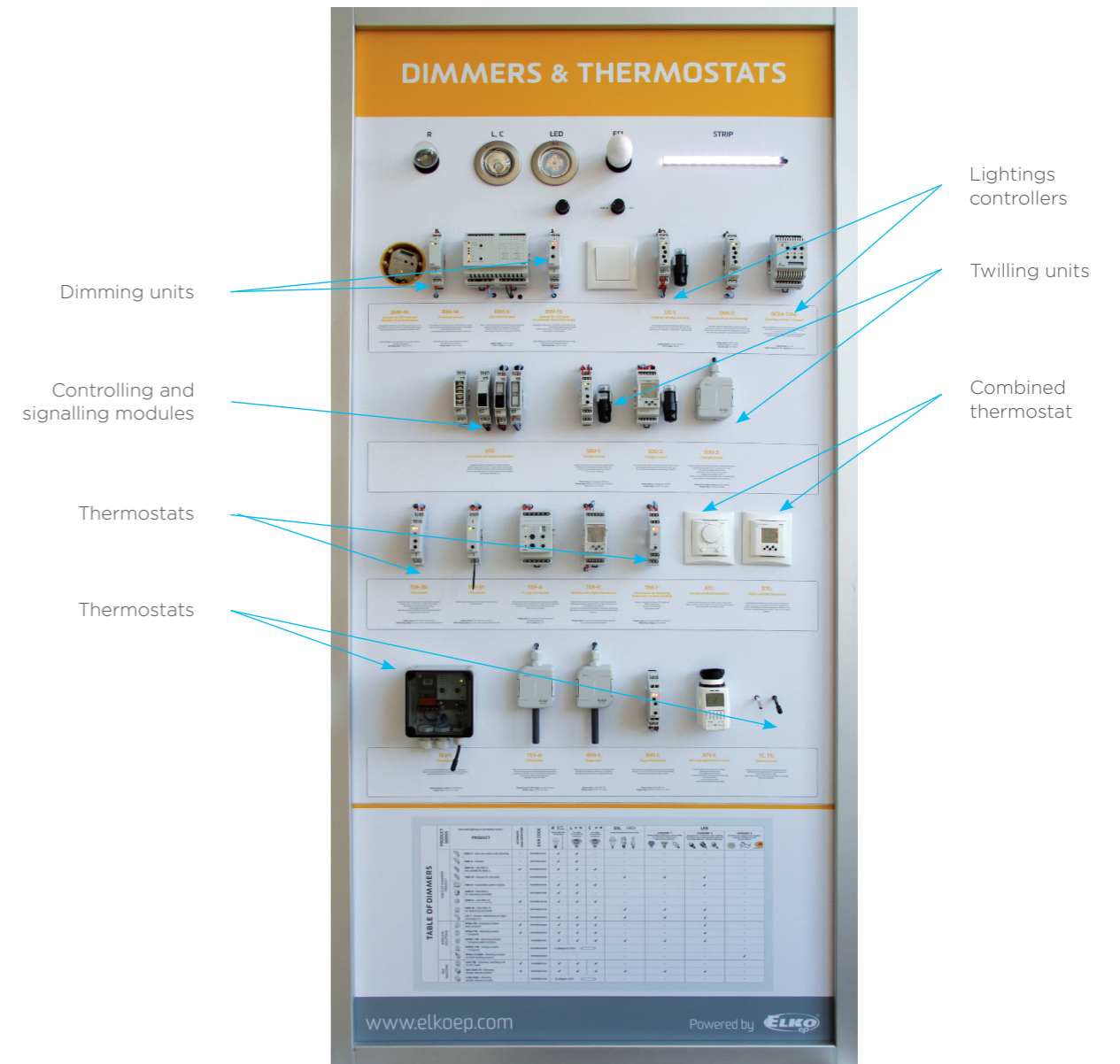
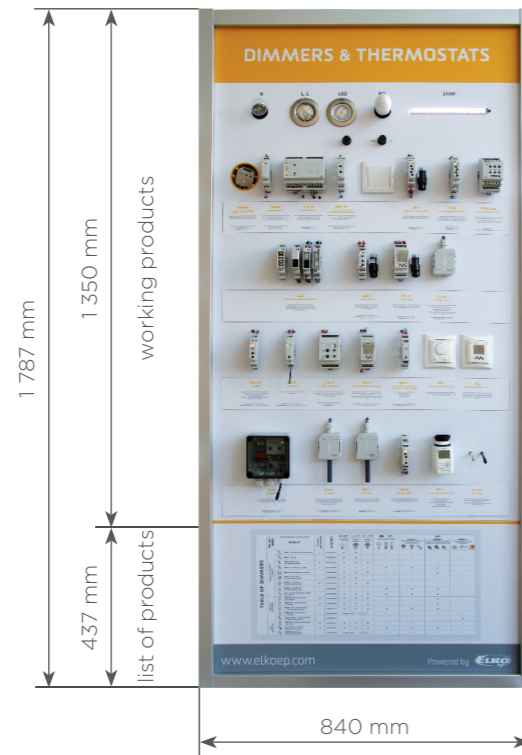

| Type | Name |
|----------------|--|
| SMR-M | Controlled dimmer |
| DIM-14 | Controlled dimmer |
| DIM-6 | Controlled dimmer |
| DIM-15 | Controlled dimmer |
| LIC-1 | Lighting intensity controller |
| DIM-2 | Staircase switch with dimming |
| DCDA-33M | Dimming actuator 3-channel |
| USS | Contolling and signalling modules |
| SOU-1 | Twilight switch |
| SOU-2 | Twilight switch |
| SOU-3 | Twilight switch |
| TER-3B, TER-3F | Thermostat |
| RHT-1 | Hygro-thermostat |
| TER-4 | 2-stage thermostat |
| TER-9 | Multifunction digital thermostat |
| TER-7 | Thermostat for monitoring temperature of motor winding |
| ATC, DTC | Analog room and floor thermostat |
| RHV-1 | Hygostat |
| TEV-1, TEV-4 | Thermostat |
| ATV-1 | Economy digital thermo-valve |
| TC, TZ | Thermosensor |

| Product number | Parameters | Price |
|----------------|------------------------------|-------|
| Code 80343 | Dimension 1787 x 840 x 80 mm | 840 € |

RELAY display (Protection & monitoring relays)

Multilanguage (sliding labels), floor standing, can be a part of the set of boards.

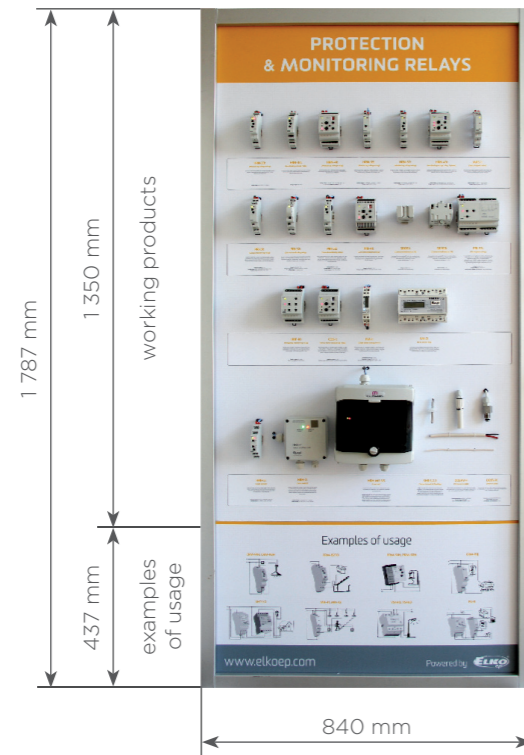

| Type | Name |
|-----------|-----------------------------------|
| HRN-34 | Monitoring voltage relay |
| HRN-34 | Monitoring voltage relay |
| HRN-41 | Monitoring voltage relay |
| HRN-55 | Monitoring voltage relay |
| HRN-57 | Monitoring voltage relay |
| HRN-43 | Monitoring voltage relay, 3-phase |
| MPS-1 | Optical signalization |
| PRI-51 | Current monitoring relay |
| PRI-32 | Current monitoring relay |
| PRI-52 | Current monitoring relay |
| PRI-41 | Current monitoring relay |
| SRO51 | Current transformer SR |
| SR200 | Current transformer SR |
| PRI-53 | Three-phase relay |
| HRF-10 | Frequency monitoring relay |
| COS-1 | Power factor monitoring relay |
| HRH-5 | Level switch |
| HRH-7 | Level switch |
| HRH-MS-VS | Level set |
| SHR-1 | Probes for level switch |
| SHR-2 | Probe for level relay |

| | |
|---------|-----------------------|
| SHR-3 | Probe for level relay |
| DO3VV-F | Tree-case cable |
| DO5V-5 | Power cable |

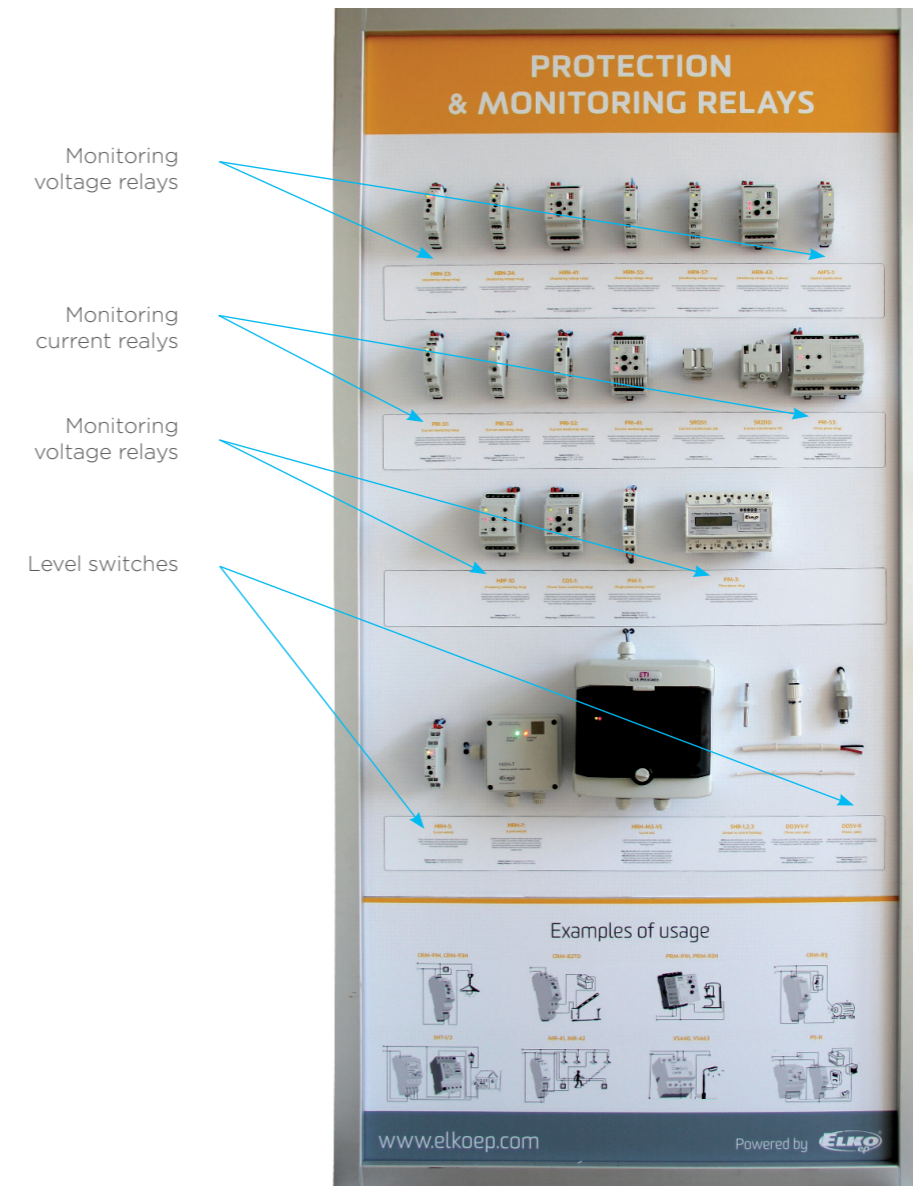

| Product number | Parameters | Price |
|----------------|-------------------------------|-------|
| Code 80344 | Dimension 1 787 x 840 x 80 mm | 674 € |

RELAY display (Timers & switches)

Multilanguage (sliding labels), floor standing, can be a part of the set of boards.

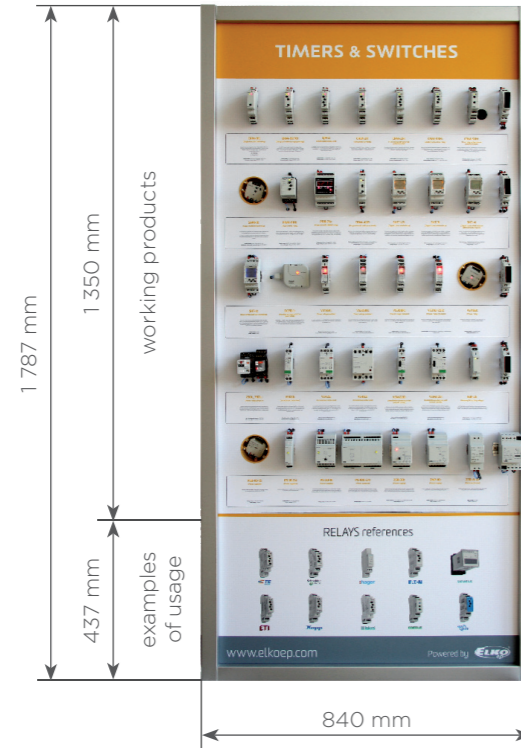

| Type | Name |
|-----------|--|
| CRM-81J | Single-function time relay |
| CRM-82TO | Delay OFF without supply voltage |
| SJR | Doublestage delay unit |
| CRM-2T | Delay On star/delta |
| CRM-2H | Time relay with external potentiometer |
| CRM-93H | Multifunction time relay |
| CRM-91H | Time relay with external potentiometer |
| SMR-B | Super-multifunction relay |
| PRM-91H | Plug-in time relay |
| PDR-2A | Programmable digital relay |
| CRM-42F | Programmable staircase switch |
| SHT-1/2 | Digital time switch clock |
| SHT-3 | Digital time switch clock |
| SHT-4 | Digital time switch with an astronomical program |
| SHT-6 | Time switch with DCF managing |
| DCFR-1 | Receiver to control SHT-6 time switch |
| VS116K | Power relays modular |
| VS308U | Power relays modular |
| VS308K | Power relays modular |
| VS316/230 | Power relays modular |
| VS116B | Power relay |

| | |
|------------|---|
| 750L, 782L | Power relays plug-in |
| VS120 | Installation contactors |
| VS425 | Installation contactors |
| VS463 | Installation contactors |
| VSM220 | Installation contactors with manual control |
| VSM425 | Installation contactors with manual control |
| MR-4 | Memory & Latching relay, 1 x output 16A |
| PSB-10-12 | Power supplies |
| PS-10-24 | Power supplies |
| PS-30-R | Switching power supply |
| PS-100-24 | Switching power supply |
| ZSR-30 | Power supply |
| ZNP-10 | Power supply |
| ZTR-8-12 | Bell transformer |

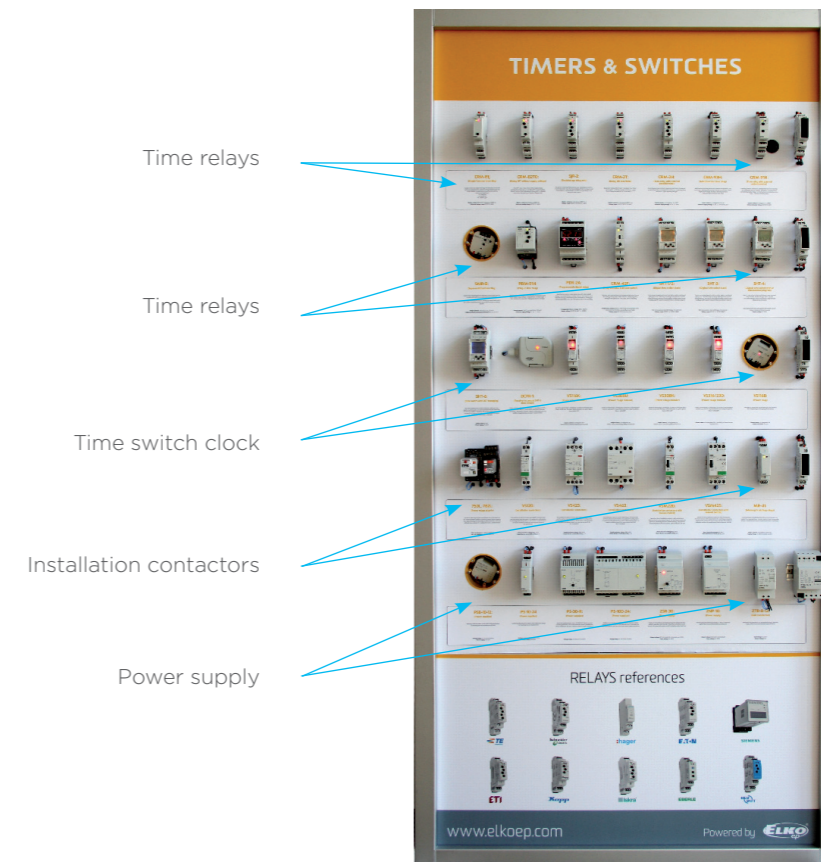

| Product number | Parameters | Price |
|----------------|-------------------------------|-------|
| Code 80345 | Dimension 1 787 x 840 x 80 mm | 729 € |

SET of iNELS Bus, iNELS RF Control, Audio/Video and Relays

Moveable, flexible size, may stand separate or in line, changable labels, transported in boxes.



Shipping boxes for desk of boards

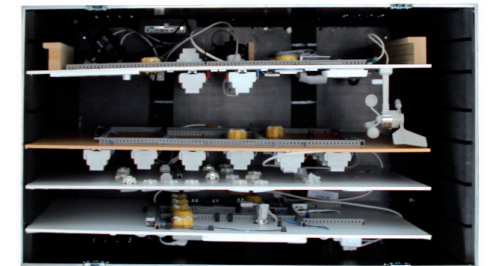
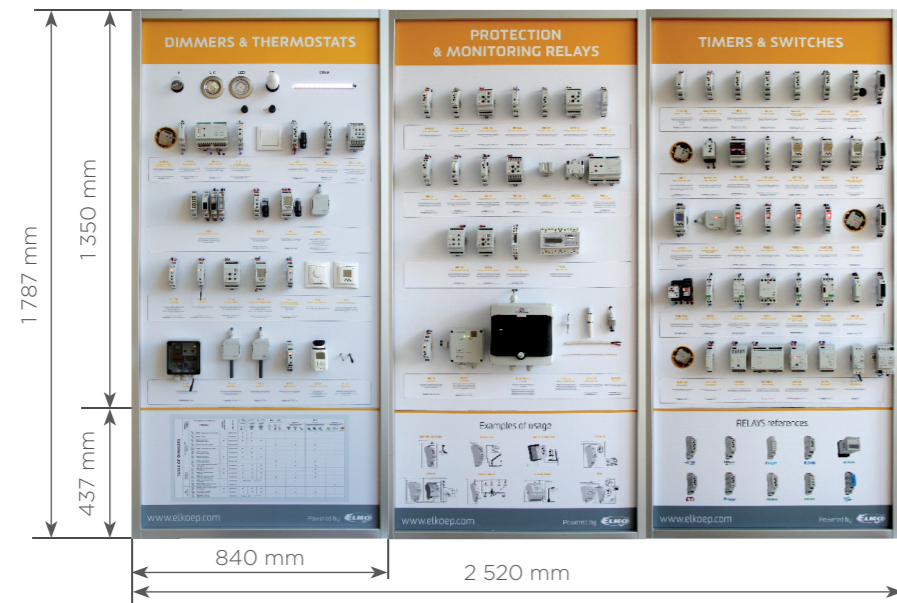

Shipping boxes for demo boards (SET PANELS)

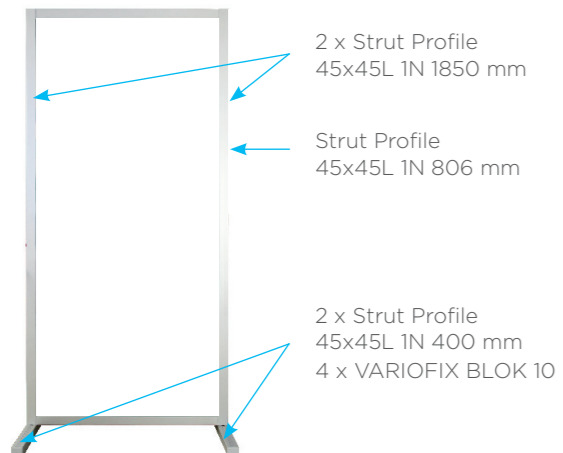

| Profiles (SET PANELS) | Code |
|---------------------------------|--------------|
| Strut Profile 45X45L 1N 400 mm | 209930601184 |
| Quick coupler N10 90DEG | 209930601186 |
| Quick coupler N10 0DEG | 209930601185 |
| Cover cap 45x45 LGR RAL7035 | 209930601188 |
| Cover cap R-AUSGLEICH 45 | 209930601187 |
| Strut Profile 45X45L 1N 806 mm | 209930601183 |
| Strut Profile 45X45L 1N 1850 mm | 209930601181 |
| Strut Profile 45X45L 2N 1850 mm | 209930601182 |
| VARIOFIX BLOK 10 | 209930601193 |
| N8/N10 Transp | 209930601197 |

Shipping boxes for HOLDERS

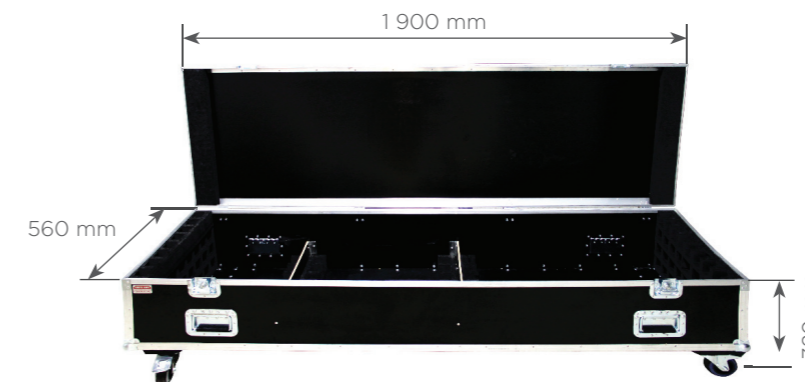

| Showroom Praha | | | | | | | | | | | |
|--------------------------|---------------------------|-----------------------|-----------------------|-----------------------|-------------------------------|-----------------------|-----------------------|-----------------------|-----------------------|-----------------------|-----------------------|
| Specialization | Intelligent installations | | Application | Camera | Ventilation and heat recovery | Heating boilers | Lighting | Home appliances | Videozone | Audiozone | Telecommunication |
| | BUS | Wireless | | | | | | | | | |
| Intelligent installation | <input type="radio"/> | <input type="radio"/> | <input type="radio"/> | <input type="radio"/> | <input type="radio"/> | <input type="radio"/> | <input type="radio"/> | <input type="radio"/> | <input type="radio"/> | <input type="radio"/> | <input type="radio"/> |



FLOORPLAN OF SHOWROOM HOLEŠOV

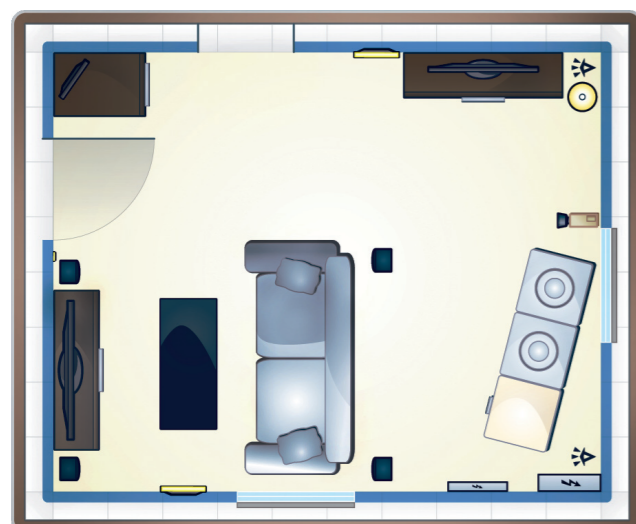

ELKO EP, s.r.o.

Palackého 493
769 01 Holešov
Czech Republic

e-mail: info@inels.com
free call: 800 100 671
web: www.inels.com

Opening hours:

Monday 8.30–15.00
Tuesday 8.30–15.00
Wednesday 8.30–15.00
Thursday 8.30–15.00
Friday 8.30–15.00
Saturday closed
Sunday closed

Showroom Praha

| Specialization | Intelligent installations | | | | | | | | | | |
|--------------------------|---------------------------|-----------------------|-----------------------|-----------------------|-------------------------------|-----------------------|-----------------------|-----------------------|-----------------------|-----------------------|-----------------------|
| | BUS | Wireless | Application | Camera | Ventilation and heat recovery | Heating boilers | Lighting | Home appliances | Videozone | Audiozone | Telecommunication |
| Intelligent installation | <input type="radio"/> | <input type="radio"/> | <input type="radio"/> | <input type="radio"/> | <input type="radio"/> | <input type="radio"/> | <input type="radio"/> | <input type="radio"/> | <input type="radio"/> | <input type="radio"/> | <input type="radio"/> |



FLOORPLAN OF SHOWROOM PRAHA



iNELS, Sykora Home

Českomoravská 183
190 00 Praha 9 - Vysočany
Czech Republic

e-mail: praha@inels.cz
tel.: +420 773 773 735
web: www.inels.com

Opening hours:

Monday 10.00–18.00
Tuesday 10.00–18.00
Wednesday 10.00–18.00
Thursday 10.00–18.00
Friday 10.00–18.00
Saturday 10.00–17.00
Sunday closed

Showroom iNELS Café

| Specialization | Intelligent installations | | | | | | | | | | |
|--------------------------|---------------------------|-----------------------|-----------------------|-----------------------|-------------------------------|-----------------------|-----------------------|-----------------------|-----------------------|-----------------------|-----------------------|
| | BUS | Wireless | Application | Camera | Ventilation and heat recovery | Heating boilers | Lighting | Home appliances | Videozone | Audiozone | Telecommunication |
| Intelligent installation | <input type="radio"/> | <input type="radio"/> | <input type="radio"/> | <input type="radio"/> | <input type="radio"/> | <input type="radio"/> | <input type="radio"/> | <input type="radio"/> | <input type="radio"/> | <input type="radio"/> | <input type="radio"/> |



FLOORPLAN OF SHOWROOM INELS CAFÉ

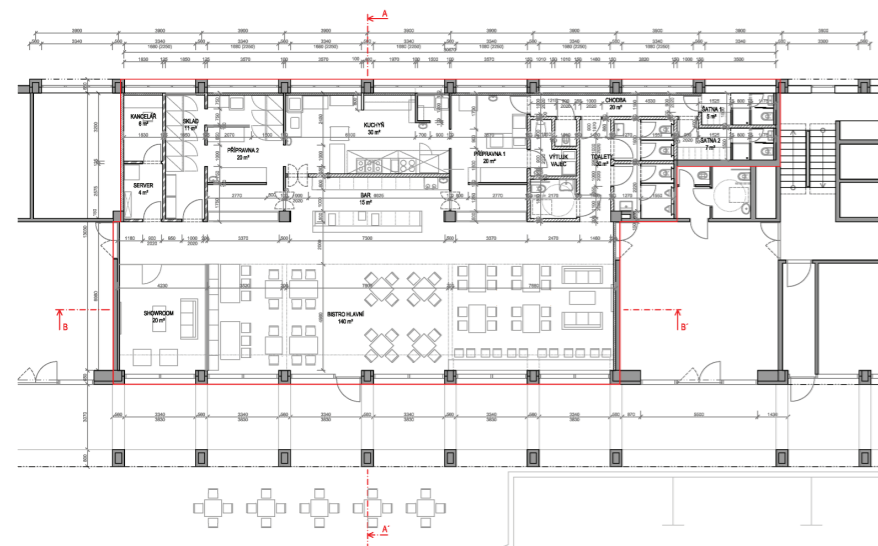

iNELS Café

Rohanské nábřeží 671/15
Praha 8-Karlín 186 00
Czech Republic

e-mail: info@inels.com
free call: 800 100 671
web: www.inels.cz/cafe

Opening hours:

| | |
|-----------|------------|
| Monday | 7.30–17.00 |
| Tuesday | 7.30–17.00 |
| Wednesday | 7.30–17.00 |
| Thursday | 7.30–17.00 |
| Friday | 7.30–17.00 |
| Saturday | closed |
| Sunday | closed |

Showroom Miele Gallery Brno

| Specialization | Intelligent installations | | | | | | | | | | |
|--------------------------|---------------------------|-----------------------|-----------------------|-----------------------|-------------------------------|-----------------------|-----------------------|-----------------------|-----------------------|-----------------------|-----------------------|
| | BUS | Wireless | Application | Camera | Ventilation and heat recovery | Heating boilers | Lighting | Home appliances | Videozone | Audiozone | Telecommunication |
| Intelligent installation | <input type="radio"/> | <input type="radio"/> | <input type="radio"/> | <input type="radio"/> | <input type="radio"/> | <input type="radio"/> | <input type="radio"/> | <input type="radio"/> | <input type="radio"/> | <input type="radio"/> | <input type="radio"/> |



FLOORPLAN OF SHOWROOM MIELE GALLERY BRNO

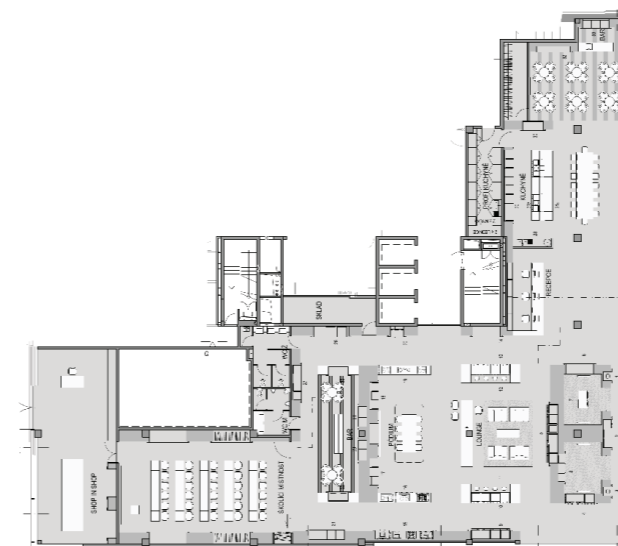

Miele, spol. s.r.o.

Holadská 4
639 00 Brno
Czech Republic

e-mail: info@miele.cz
tel.: +420 543 553 111
web: www.miele.cz

Opening hours:

| | |
|-----------|-------------|
| Monday | 9.00–18.00 |
| Tuesday | 9.00–18.00 |
| Wednesday | 9.00–18.00 |
| Thursday | 9.00–18.00 |
| Friday | 9.00–18.00 |
| Saturday | 10.00–16.00 |
| Sunday | closed |

| Showroom Diamond Design Praha | | | | | | | | | | | |
|-------------------------------|---------------------------|-----------------------|-----------------------|--------|-------------------------------|-----------------|-----------------------|-----------------------|-----------|-----------|-------------------|
| Specialization | Intelligent installations | | Application | Camera | Ventilation and heat recovery | Heating boilers | Lighting | Home appliances | Videozone | Audiozone | Telecommunication |
| | BUS | Wireless | | | | | | | | | |
| Intelligent installation | | <input type="radio"/> | <input type="radio"/> | | | | <input type="radio"/> | <input type="radio"/> | | | |



FLOORPLAN OF SHOWROOM DIAMOND DESIGN PRAHA



Diamond Design

Rohanské nábřeží 671/15
Praha 8, 186 00
Czech Republic

e-mail: fi.kr@diamonddesign.cz
tel.: +420 777 799 270
web: www.diamonddesign.cz

Opening hours:

| | | |
|-----------|------------|-------------|
| Monday | 9.30–13.00 | 13.30–18.00 |
| Tuesday | 9.30–13.00 | 13.30–18.00 |
| Wednesday | 9.30–13.00 | 13.30–18.00 |
| Thursday | 9.30–13.00 | 13.30–18.00 |
| Friday | 9.30–13.00 | 13.30–18.00 |
| Saturday | closed | |
| Sunday | closed | |

| Showroom Amman (Jordan) | | | | | | | | | | | |
|--------------------------|---------------------------|-----------------------|-----------------------|--------|-------------------------------|-----------------|-----------------------|-----------------|-----------------------|-----------------------|-----------------------|
| Specialization | Intelligent installations | | Application | Camera | Ventilation and heat recovery | Heating boilers | Lighting | Home appliances | Videozone | Audiozone | Telecommunication |
| | BUS | Wireless | | | | | | | | | |
| Intelligent installation | <input type="radio"/> | <input type="radio"/> | <input type="radio"/> | | | | <input type="radio"/> | | <input type="radio"/> | <input type="radio"/> | <input type="radio"/> |



FLOORPLAN OF SHOWROOM AMMAN



Special light company

Khalda - amir bin malek s. t.
P. O. Box 4394 Amman
Jordan

e-mail: speciallightcompany@yahoo.com

Opening hours:

| | |
|-----------|------------|
| Monday | 9.00–18.00 |
| Tuesday | 9.00–18.00 |
| Wednesday | 9.00–18.00 |
| Thursday | 9.00–18.00 |
| Friday | closed |
| Saturday | 9.00–18.00 |
| Sunday | 9.00–18.00 |

| Showroom Istanbul (Turkey) | | | | | | | | | | | |
|----------------------------|---------------------------|-----------------------|-----------------------|--------|-------------------------------|-----------------|-----------------------|-----------------|-----------|-----------------------|-------------------|
| Specialization | Intelligent installations | | Application | Camera | Ventilation and heat recovery | Heating boilers | Lighting | Home appliances | Videozone | Audiozone | Telecommunication |
| | BUS | Wireless | | | | | | | | | |
| Intelligent installation | <input type="radio"/> | <input type="radio"/> | <input type="radio"/> | | | | <input type="radio"/> | | | <input type="radio"/> | |



FLOORPLAN OF SHOWROOM TURAN

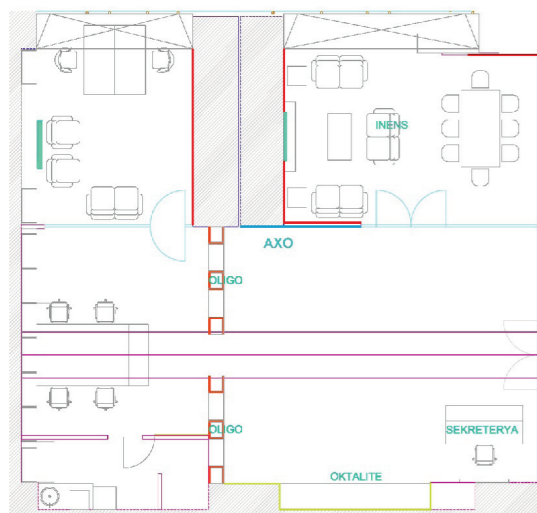

INELS showroom

Beyoglu
34420, Istanbul
TURKEY

e-mail: cturan@turanmuhendislik.com.tr
web: www.turanmuhendislik.com.tr

Car on wheels

Presentation of iNELS BUS system and iNELS RF Control inside the car. Presentation is intended for end user. Used for presentation near shopping centers, during the exhibitions or other special occasions.

Interior of car on wheels



Exterior of car on wheels



ELKO EP Holding



www.elkoep.com